

**INTERNATIONAL HYDROGRAPHIC ORGANIZATION**

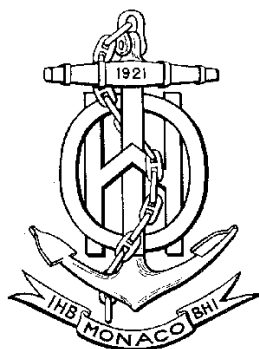

*Special Publication No. 52, Appendix 2*

**COLOUR & SYMBOL SPECIFICATIONS FOR ECDIS**

*Edition 4.3 – January 2008*

*and its Annex A*

**IHO ECDIS PRESENTATION LIBRARY**

*Edition 3.4 – January 2008*

**C & S MAINTENANCE DOCUMENT**

**Number 7 – October 2009**

**DEFERRED AMENDMENT 8**

**Published by the  
International Hydrographic Bureau**

4, Quai Antoine 1er  
B.P. 445 - MC 98011 MONACO Cedex  
Principauté de Monaco  
Telefax: (377) 93 10 81 40  
E-mail: [info@ihb.mc](mailto:info@ihb.mc)  
Web-site: [www.iho-ohi.net](http://www.iho-ohi.net)

**Page intentionally left blank**

## Introduction

Amendments to S-52 Appendix 2 affect primarily the ECDIS manufacturers, though the mariners will benefit from the improvements made. The procedures for amending S-52 Appendix 2 include both immediate and deferred amendments. Definitions and procedures for these amendments are given in S-52 App.2 "Colour & Symbol Specifications for ECDIS" (C&S Specs), section 1.2.4.1, but are as follows:

An amendment in general may be of the following two different types:

- a deferred amendment may contain either:
  - (a) clarifications and deferred correction items, or
  - (b) extension items, which are distributed separately.
- an immediate amendment which contains only items to be applied urgently,

A deferred amendment is not included in any S-52 Appendix 2 document until the new edition which is identified as bringing the deferred amendments into force. However OEMs may apply such deferred amendments at any time after their publication and do not have to wait for the implementation date of the new edition.

An immediate amendment is issued only in exceptional cases. It applies solely to corrections and extensions which directly affect safety of navigation. Immediate amendments have to be implemented to ECDIS under production and in the field at the earliest opportunity. An immediate amendment to the C&S Specs or Presentation Library (PresLib) changes the Edition number. It applies only to corrections, which must not depend on any deferred amendment.

The item number of each amendment item gives the edition number of the C&S Specs or the PresLib to which the amendment item applies. This Edition number will change once an immediate amendment is applied, but does not change for a deferred amendment.

At the end of each immediate amendment, there is a reminder of the current Edition number after the amendment is applied.

---

**Page intentionally left blank**

**S-52 APP. 2 – DEFERRED AMENDMENT 8  
October 2009**

NOTES

1. These amendments are intended to remind users of S-52 Appendix 2 of the changes approved at the meeting CSMWG 18, Cape Town, May 2008 and to point out how these changes affect C&S Specifications Edition 4.3 and PresLib Edition 3.4 in detail.
2. CHANGE HISTORY OF S-52 APP.2 FROM CSMWG SPECS 4.0 --> 4.3 AND PRESLIB 3.0-->3.4 FROM 1997 TO 2008

'MD' stands for IHO Maintenance Document; 'IA' stands for Immediate Amendment; and 'DA' stands for Deferred Amendment:

**Colours & Symbols Specifications (S-52 Appendix 2)**

- Edition 4.0 (July 1997) + MD1 IA i01 --> Edition 4.1 (January 1999)
- Edition 4.1 + MD2 DA d02 + MD4 DA d6 --> Edition 4.2 (March 2004)
- Edition 4.2 + MD5 DA d7 → Edition 4.3 (January 2008)

**Presentation Library (Annex A to S-52 Appendix 2)**

- Edition 3.0 (July 1997) + MD1 IA i01 → Edition 3.1 (January 1999)
- Edition 3.1 + MD 3 IA i04 --> Edition 3.2 (May 2000)
- Edition 3.2 + MD2 DA d02 + MD3 DA d05 + MD4 DA d6 → Edition 3.3 (2004)
- Edition 3.3 + MD5 IA i5 + MD5 DA d7 → Edition 3.4 (January 2008)
- Edition 3.4 + MD7 DA d8 (May 2009)
- Digital versions:
  - PRSLIB03.dai (July 1997),
  - PSLB03\_1.dai (December 1998),
  - PSLB03\_2.dai (May 2000),
  - PSLB03\_3.dai (March 2004),
  - PSLB03\_4.dai (January 2008),
- Temporary digital files: PSTY03\_0.dai (June 1999), PSTY3\_2b.dai (October 2001) (see amendment d05.cl.005)
- Paper based description of symbols:
  - Addendum to Part I, Users' Manual (2003)
  - Addendum to Part I, Users' Manual (2007)
  - Addendum to Part I, Users' Manual (2008), Edition 3.4

Edition 3.4 of the PresLib, was triggered by the introduction of new objects, object attributes and attribute values in S-57 Supplement No. 1, issued in January 2007. Edition 3.4 of the PresLib itself is to be set in force in conjunction with the S-57 Supplement No. 1 by 1 January 2008.

**TSMAD and CSMWG commonly identified minor deficiencies of PresLib 3.4 and supplement the affected clauses by means of this Maintenance Document No. 7 dated October 2009 for the following amendments:**

**INDEX OF ITEMS IN DEFERRED AMENDMENT 8**

<u>Item No. PL03.4.d8.co.1</u>	Correction and Addition to PresLib Look-up table <b>correct DGPS symbol</b>	p. 2
<u>Item No. PL03.4.d8.ad.2</u>	Addition to PresLib Look-up table <b>point and area objects</b>	p. 2
<u>Item No. PL03.4.d8.ad.3</u>	Addition to PresLib symbol description (Users' Manual Addendum) <b>CHECKPOINT symbol</b>	p. 39
<u>Item No. PL03.4.d8.co.4</u>	Correction and Addition to List of symbol names & meaning <b>correct several table entries</b>	p. 40
<u>Item No. PL03.4.d8.ad.5</u>	Addition of TECSOU = 4 (found by diver) to harmonise wreck symbolisation with INT 1 <b>SNDFRM04</b>	p. 42

**S-52 APP. 2 – DEFERRED AMENDMENT 8**

*Throughout this amendment changes to the CSMWG Specs. and the PresLib. are indicated by ~~strikethrough~~ text for deletions and **bold text** for additions.*

Item No. PL03.4.d8.co.1 Correction to PresLib Look-up table  
**correct DGPS symbol**

Item No.PL03.4.d8.ad.2 Addition to PresLib Look-up table  
**point and area objects**

Item No.PL03.4.d8.ad.3 Addition to PresLib symbol description (Users' Manual Addendum)  
**CHECKPOINT symbol**

Item No. PL03.4.d8.co.1 Correction to PresLib Look-up table  
**correct DGPS symbol**

Corrected look up table entries see gray shaded entries for **RDOSTA** under Look up table listings contained in Item No.PL03.4.d8.ad.2 below

Item No.PL03.4.d8.ad.2 Addition to PresLib Look-up table  
**point and area objects**

## 11. LOOK-UP TABLE LISTINGS

The Presentation Library provides five look-up tables:

- 1a. paper chart point symbols (buoys and beacons are similar to the paper chart)
- 1b. simplified point symbols (buoys and beacons are more prominent)
2. line symbols
- 3a. area symbols with plain boundaries (for general use)
- 3b. area symbols with symbolized boundaries (for large scale display)

The ECDIS should provide all of these and make the options available to the mariner.

Some of the look-up table entries describe the presentation of mariners' navigational objects. Please see Part II of the PresLib for further details and definitions of mariners' navigational object classes.

See 8.3 for further explanation how to use the look-up tables.



## 11.1 Look-Up Table Listing for Object Type Point 'P'

### 11.1.1 Look-up Table for paper chart point symbolization

\* \*\*\* PAPER CHART POINTS \*\*\*

\* \*\*\* This is the look-up table for point symbolization. \*\*\*

\* \*\*\* For edition 3.4 Preslib, dated January 2008 \*\*\*\*\*

\*

\* Each line contains minimum 6 fields:

- \* 1. field - code of the object class
- \* 2. field - attribute combination
- \* 3. field - symbolization instruction
- \* 4. field - display priority
- \* 5. field - radar
- \* 6. field - IMO display category
- \* 7. field - viewing group (optional)

\*

\* Each field entry is framed by "" and fields are separated by ','.

\*

\* Please note, that the entries to this table must be in

\* alphabetic order (sorted by the class code).

\*

\* This table has 2 sections:

\*

\* - The first section contains symbolization instructions for

\* standard S-57 'real world' objects:

\* - The second section contains symbolization instructions for

\* non-standard (class code in lowercase) objects:

\*

\* default for symbolization failure; must be the first entry to look-up table

"#####", "", "SY(QUESMRK1)", "5", "O", "STANDARD", "21010"





"BUISGL","FUNCTN33CONVIS1OBJNAM","SY(POSGEN03);TX(OBJNAM,3,2,2,'15110',1,0,CHBLK,26)","6","O","STANDARD","22220"  
 "BUISGL","FUNCTN20CONVIS1","SY(BUIREL13)","6","O","STANDARD","22220"  
 "BUISGL","FUNCTN21CONVIS1","SY(BUIREL13)","6","O","STANDARD","22220"  
 "BUISGL","FUNCTN22CONVIS1","SY(BUIREL14)","6","O","STANDARD","22220"  
 "BUISGL","FUNCTN23CONVIS1","SY(BUIREL14)","6","O","STANDARD","22220"  
 "BUISGL","FUNCTN24CONVIS1","SY(BUIREL14)","6","O","STANDARD","22220"  
 "BUISGL","FUNCTN25CONVIS1","SY(BUIREL14)","6","O","STANDARD","22220"  
 "BUISGL","FUNCTN26CONVIS1","SY(BUIREL15)","6","O","STANDARD","22220"  
 "BUISGL","FUNCTN27CONVIS1","SY(BUIREL15)","6","O","STANDARD","22220"  
 "BUISGL","FUNCTN33CONVIS1","SY(POSGEN03)","6","O","STANDARD","22220"  
 "BUISGL","FUNCTN35CONVIS1","SY(TNKCON12)","6","O","STANDARD","22220"  
 "BUISGL","FUNCTN33OBJNAM","SY(POSGEN03);TX(OBJNAM,3,2,2,'15110',1,0,CHBLK,26)","4","O","OTHER","32220"  
 "BUISGL","CONVIS1","SY(BUISGL11)","6","O","STANDARD","22220"  
 "BUISGL","FUNCTN20","SY(BUIREL01)","4","O","OTHER","32220"  
 "BUISGL","FUNCTN21","SY(BUIREL01)","4","O","OTHER","32220"  
 "BUISGL","FUNCTN22","SY(BUIREL04)","4","O","OTHER","32220"  
 "BUISGL","FUNCTN23","SY(BUIREL04)","4","O","OTHER","32220"  
 "BUISGL","FUNCTN24","SY(BUIREL04)","4","O","OTHER","32220"  
 "BUISGL","FUNCTN25","SY(BUIREL04)","4","O","OTHER","32220"  
 "BUISGL","FUNCTN26","SY(BUIREL05)","4","O","OTHER","32220"  
 "BUISGL","FUNCTN27","SY(BUIREL05)","4","O","OTHER","32220"  
 "BUISGL","FUNCTN33","SY(POSGEN03)","4","O","OTHER","32220"  
 "BUISGL","FUNCTN35","SY(TNKCON02)","4","O","OTHER","32220"  
 "CGUSTA","SY(CGUSTA02)","7","O","OTHER","38030"  
**CHKPNT**  
**CHKPNT","SY(CHKPNT01)","4","S","OTHER","32410"**  
 "CRANES","SY(CRANES01)","4","O","OTHER","32440"  
 "CTNARE","SY(CHINFO06)","4","O","STANDARD","26050"  
 "CTRPNT","SY(POSGEN04)","4","O","OTHER","32250"  
 "CTSARE","SY(CHINFO07)","4","O","STANDARD","26250"  
**CURRENT**  
**CURRENT","SY(CURDEF01)","5","O","OTHER","33000"**  
 "CURRENT","ORIENTCURVEL","SY(CURRENT01,ORIENT);TE('%4.1f kn','CURVEL',3,1,2,'15110',1,-1,CHBLK,31)","5","O","OTHER","33060"  
 "CURRENT","ORIENT","SY(CURRENT01,ORIENT)","5","O","OTHER","33060"  
 "DAMCON","CATDAM3","SY(CHINFO06)","4","O","STANDARD","22010"  
 "DAYMAR","SY(DAYSQR21);TE('bn %s','OBJNAM',2,1,2,'15110',-1,-1,CHBLK,21)","7","O","STANDARD","27025"  
 "DAYMAR","TOPSHP19","SY(DAYSQR21);TE('bn %s','OBJNAM',2,1,2,'15110',-1,-1,CHBLK,21)","7","O","STANDARD","27025"  
 "DAYMAR","TOPSHP20","SY(DAYSQR21);TE('bn %s','OBJNAM',2,1,2,'15110',-1,-1,CHBLK,21)","7","O","STANDARD","27025"  
 "DAYMAR","TOPSHP21","SY(DAYSQR21);TE('bn %s','OBJNAM',2,1,2,'15110',-1,-1,CHBLK,21)","7","O","STANDARD","27025"  
 "DAYMAR","TOPSHP24","SY(DAYTRI21);TE('bn %s','OBJNAM',2,1,2,'15110',-1,-1,CHBLK,21)","7","O","STANDARD","27025"  
 "DAYMAR","TOPSHP25","SY(DAYTRI25);TE('bn %s','OBJNAM',2,1,2,'15110',-1,-1,CHBLK,21)","7","O","STANDARD","27025"  
 "DISMAR","SY(DISMAR03);TX(INFORM,2,1,2,'15110',2,0,CHBLK,21)","7","O","OTHER","32430"  
 "DISMAR","CATDIS1","SY(DISMAR04);TX(INFORM,2,1,2,'15110',2,0,CHBLK,21)","7","O","OTHER","32430"  
 "DMPGRD","SY(CHINFO07)","4","O","STANDARD","26240"  
 "FOGSIG","SY(FOGSIG01)","6","O","STANDARD","27080"  
 "FORSTC","SY(FORSTC01)","4","O","OTHER","32220"  
 "FORSTC","CONVIS1","SY(FORSTC11)","4","O","STANDARD","22220"  
 "FSHFAC","SY(FSHHAV01)","4","O","OTHER","34040"

"FSHFAC","CATFIF1","SY(FSHFAC03)","4","O","OTHER","34040"  
 "FSHFAC","CATFIF2","SY(FSHFAC02)","4","O","OTHER","34040"  
 "FSHFAC","CATFIF3","SY(FSHFAC02)","4","O","OTHER","34040"  
 "FSHFAC","CATFIF4","SY(FSHFAC02)","4","O","OTHER","34040"  
 "GATCON","SY(GATCON04)","8","O","STANDARD","22010"  
 "GATCON","CATGAT2","SY(GATCON04)","8","O","STANDARD","22010"  
 "GATCON","CATGAT3","SY(GATCON04)","8","O","OTHER","32440"  
 "GATCON","CATGAT4","SY(GATCON03)","8","O","OTHER","32440"  
 "GRIDRN","","",""  
 "HRBFAC","SY(CHINFO07)","4","O","OTHER","32410"  
 "HRBFAC","CATHAF1","SY(ROLROL01)","4","O","OTHER","32410"  
 "HRBFAC","CATHAF4","SY(HRBFAC09)","4","O","OTHER","32410"  
 "HRBFAC","CATHAF5","SY(SMCFAC02)","4","O","OTHER","32410"  
 "HULKES","SY(HULKES01)","5","O","DISPLAYBASE","12410"  
 "ICNARE","SY(CHINFO07)","4","O","STANDARD","26250"  
 "LIGHTS","CS(LIGHTS05)","8","O","STANDARD","27070"  
 "LITFLT","SY(LITFLT01);TE('by %s','OBJNAM',2,1,2,'15110',-1,-1,CHBLK,21)";"8","O","STANDARD","27010"  
 "LITVES","SY(LITVES01);TE('Ltv %s','OBJNAM',2,1,2,'15110',-1,-1,CHBLK,21)";"8","O","STANDARD","27011"  
 "LNDARE","SY(LNDARE01);TX(OBJNAM,1,2,2,'15110',0,1,CHBLK,26);CS(QUAPOS01)";"4","O","DISPLAYBASE","12010"  
 "LNDELV","SY(POSGEN04);TE('%3.0lf m','ELEVAT',3,2,2,'15110',1,0,CHBLK,28)";"4","O","OTHER","32010"  
 "LNDMRK","SY(POSGEN01)","4","O","OTHER","32220"  
 "LNDMRK","CATLMK17FUNCTN33CONVIS1","SY(TOWERS03);TX(OBJNAM,3,2,2,'15110',1,-1,CHBLK,26)";"6","O","STANDARD","22220"  
 "LNDMRK","CATLMK15FUNCTN20CONVIS1","SY(BUIREL13)";"6","O","STANDARD","22220"  
 "LNDMRK","CATLMK15FUNCTN21CONVIS1","SY(BUIREL13)";"6","O","STANDARD","22220"  
 "LNDMRK","CATLMK17FUNCTN20CONVIS1","SY(BUIREL13)";"6","O","STANDARD","22220"  
 "LNDMRK","CATLMK17FUNCTN21CONVIS1","SY(BUIREL13)";"6","O","STANDARD","22220"  
 "LNDMRK","CATLMK20FUNCTN20CONVIS1","SY(BUIREL13)";"6","O","STANDARD","22220"  
 "LNDMRK","CATLMK20FUNCTN21CONVIS1","SY(BUIREL13)";"6","O","STANDARD","22220"  
 "LNDMRK","CATLMK20FUNCTN26CONVIS1","SY(BUIREL15)";"6","O","STANDARD","22220"  
 "LNDMRK","CATLMK20FUNCTN27CONVIS1","SY(BUIREL15)";"6","O","STANDARD","22220"  
 "LNDMRK","CATLMK17FUNCTN33","SY(TOWERS01);TX(OBJNAM,3,2,2,'15110',1,-1,CHBLK,26)";"4","O","OTHER","32220"  
 "LNDMRK","CATLMK1CONVIS1","SY(CAIRNS11)";"6","O","STANDARD","22220"  
 "LNDMRK","CATLMK3CONVIS1","SY(CHIMNY11)";"6","O","STANDARD","22220"  
 "LNDMRK","CATLMK4CONVIS1","SY(DSHAER11)";"6","O","STANDARD","22220"  
 "LNDMRK","CATLMK5CONVIS1","SY(FLGSTF01)";"6","O","STANDARD","22220"  
 "LNDMRK","CATLMK6CONVIS1","SY(FLASTK11)";"6","O","STANDARD","22220"  
 "LNDMRK","CATLMK7CONVIS1","SY(MSTCON14)";"6","O","STANDARD","22220"  
 "LNDMRK","CATLMK8CONVIS1","SY(POSGEN03)";"6","O","STANDARD","22220"  
 "LNDMRK","CATLMK9CONVIS1","SY(MONUMT12)";"6","O","STANDARD","22220"  
 "LNDMRK","CATLMK10CONVIS1","SY(MONUMT12)";"6","O","STANDARD","22220"  
 "LNDMRK","CATLMK12CONVIS1","SY(MONUMT12)";"6","O","STANDARD","22220"  
 "LNDMRK","CATLMK13CONVIS1","SY(MONUMT12)";"6","O","STANDARD","22220"  
 "LNDMRK","CATLMK15CONVIS1","SY(DOMES011)";"6","O","STANDARD","22220"  
 "LNDMRK","CATLMK16CONVIS1","SY(RASCAN11)";"6","O","STANDARD","22220"  
 "LNDMRK","CATLMK17CONVIS1","SY(TOWERS03)";"6","O","STANDARD","22220"  
 "LNDMRK","CATLMK18CONVIS1","SY(WNDMIL12)";"6","O","STANDARD","22220"  
 "LNDMRK","CATLMK19CONVIS1","SY(WIMCON11)";"6","O","STANDARD","22220"  
 "LNDMRK","CATLMK20CONVIS1","SY(POSGEN03)";"6","O","STANDARD","22220"  
 "LNDMRK","CATLMK20FUNCTN20","SY(BUIREL01)";"4","O","OTHER","32220"

"LNDMRK","CATLMK1","SY(CAIRNS01)","4","O","OTHER","32220"  
 "LNDMRK","CATLMK3","SY(CHIMNY01)","4","O","OTHER","32220"  
 "LNDMRK","CATLMK4","SY(DSHAER01)","4","O","OTHER","32220"  
 "LNDMRK","CATLMK5","SY(FLGSTF01)","4","O","OTHER","32220"  
 "LNDMRK","CATLMK6","SY(FLASTK01)","4","O","OTHER","32220"  
 "LNDMRK","CATLMK7","SY(MSTCON04)","4","O","OTHER","32220"  
 "LNDMRK","CATLMK8","SY(POSGEN03)","4","O","OTHER","32220"  
 "LNDMRK","CATLMK9","SY(MONUMT02)","4","O","OTHER","32220"  
 "LNDMRK","CATLMK10","SY(MONUMT02)","4","O","OTHER","32220"  
 "LNDMRK","CATLMK12","SY(MONUMT02)","4","O","OTHER","32220"  
 "LNDMRK","CATLMK13","SY(MONUMT02)","4","O","OTHER","32220"  
 "LNDMRK","CATLMK15","SY(DOMES001)","4","O","OTHER","32220"  
 "LNDMRK","CATLMK16","SY(RASCAN01)","4","O","OTHER","32220"  
 "LNDMRK","CATLMK17","SY(TOWERS01)","4","O","OTHER","32220"  
 "LNDMRK","CATLMK18","SY(WNDMIL02)","4","O","OTHER","32220"  
 "LNDMRK","CATLMK19","SY(WIMCON01)","4","O","OTHER","32220"  
 "LNDMRK","CATLMK20","SY(POSGEN01)","4","O","OTHER","32220"  
 "LNDMRK","CONVIS1","SY(POSGEN03)","6","O","STANDARD","22220"  
 "LNDRGN","","SY(POSGEN04);TX(OBJNAM,1,2,2,'15110',0,-1,CHBLK,26)","4","O","STANDARD","21060"  
 "LOCMAG","","SY(LOCMAG01)","4","O","OTHER","31080"  
 "LOGPON","","SY(FLTHAZ02)","4","O","OTHER","34050"  
 "M\_NPUB","","SY(CHINFO07)","4","O","OTHER","31020"  
 "MAGVAR","","SY(MAGVAR01);TX(VALMAG,3,1,2,'15110',1,-1,CHBLK,27)","4","O","OTHER","31080"  
 "MARCUL","","SY(MARCUL02)","4","O","STANDARD","26210"  
 "MIPARE","","SY(CHINFO06)","4","O","STANDARD","26040"  
 "MORFAC","","SY(MORFAC03)","6","O","DISPLAYBASE","12410"  
 "MORFAC","CATMOR7BOYSHP3","SY(BOYMOR01)","8","O","STANDARD","27010"  
 "MORFAC","CATMOR7BOYSHP6","SY(BOYMOR03)","8","O","STANDARD","27010"  
 "MORFAC","CATMOR1","SY(MORFAC03)","6","O","DISPLAYBASE","12410"  
 "MORFAC","CATMOR2","SY(MORFAC04)","6","O","DISPLAYBASE","12410"  
 "MORFAC","CATMOR3","SY(PILPNT02)","6","O","OTHER","32440"  
 "MORFAC","CATMOR5","SY(PILPNT02)","6","O","DISPLAYBASE","12410"  
 "MORFAC","CATMOR7","SY(BOYMOR11)","8","O","STANDARD","27010"  
 "NEWOBJ","","SY(NEWOBJ01)","6","S","STANDARD","21020"  
 "NEWOBJ","SYMINS","CS(SYMINS01)","6","S","STANDARD","21020"  
 "OBSTRN","","CS(OBSTRN06)","4","O","OTHER","34050"  
 "OBSTRN","CATOBS7VALSOU","SY(FOULGND1)","4","O","OTHER","34051"  
 "OBSTRN","CATOBS8VALSOU","SY(FLTHAZ02)","4","O","OTHER","34051"  
 "OBSTRN","CATOBS9VALSOU","SY(ACHARE02)","4","O","OTHER","34051"  
 "OBSTRN","CATOBS10VALSOU","SY(FLTHAZ02)","4","O","OTHER","34051"  
 "OBSTRN","CATOBS7","SY(FOULGND1)","4","O","OTHER","34050"  
 "OBSTRN","CATOBS8","SY(FLTHAZ02)","4","O","OTHER","34050"  
 "OBSTRN","CATOBS9","SY(ACHARE02)","4","O","OTHER","34050"  
 "OBSTRN","CATOBS10","SY(FLTHAZ02)","4","O","OTHER","34050"  
 "OBSTRN","WATLEV7","SY(FLTHAZ02)","4","O","DISPLAYBASE","12410"  
 "OFSPLF","","SY(OFSPLF01);TE('Prod %s','OBJNAM',3,1,2,'15110',1,-1,CHBLK,21)","5","O","DISPLAYBASE","12210"  
 "PILBOP","","SY(PILBOP02);TE('Plt %s','OBJNAM',3,1,2,'15110',1,-1,CHBLK,21)","6","O","STANDARD","28010"  
 "PILPNT","","SY(PILPNT02)","5","O","DISPLAYBASE","12410"  
 "PIPARE","","SY(CHINFO07)","4","O","STANDARD","26230"

"PIPSOL", "", "", "", "", "", ""  
 "PRCARE", "", "SY(PRCARE12)", "5", "O", "STANDARD", "25010"  
 "PRDARE", "", "", "", "", "", ""  
 "PRDARE", "CATPRA5CONVIS1", "SY(FLASTK11)", "4", "O", "STANDARD", "22220"  
 "PRDARE", "CATPRA8CONVIS1", "SY(TNKCON12)", "4", "O", "STANDARD", "22220"  
 "PRDARE", "CATPRA9CONVIS1", "SY(WIMCON11)", "4", "O", "STANDARD", "22220"  
 "PRDARE", "CATPRA1", "SY(PRDINS02)", "34", "O", "OTHER", "32270"  
 "PRDARE", "CATPRA2", "SY(PRDINS02)", "4", "O", "OTHER", "32270"  
 "PRDARE", "CATPRA3", "SY(PRDINS02)", "4", "O", "OTHER", "32270"  
 "PRDARE", "CATPRA4", "SY(PRDINS02)", "4", "O", "OTHER", "32270"  
 "PRDARE", "CATPRA5", "SY(FLASTK01)", "34", "O", "OTHER", "32270"  
 "PRDARE", "CATPRA6", "SY(TMBYRD01)", "34", "O", "OTHER", "32270"  
 "PRDARE", "CATPRA7", "SY(PRDINS02)", "4", "O", "OTHER", "32270"  
 "PRDARE", "CATPRA8", "SY(TNKCON02)", "34", "O", "OTHER", "32270"  
 "PRDARE", "CATPRA9", "SY(WIMCON01)", "34", "O", "OTHER", "32270"  
 "PRDARE", "CATPRA10", "SY(PRDINS02)", "4", "O", "OTHER", "32270"  
 "PYLONS", "", "SY(POSGEN03)", "8", "O", "DISPLAYBASE", "12210"  
 "RADRFL", "", "SY(RADRFL03)", "6", "O", "STANDARD", "27230"  
 "RADSTA", "", "SY(POSGEN01)", "5", "O", "OTHER", "38010"  
 "RADSTA", "CATRAS2", "SY(RDOSTA02);TE('ch %s', 'COMCHA', 3, 1, 2, '15110', 0, 0, CHBLK, 11)", "5", "O", "OTHER", "38010"  
 "RAPIDS", "", "", "", "", "", ""  
 "RCTLPT", "", "SY(RTLDEF51)", "4", "O", "STANDARD", "25020"  
 "RCTLPT", "ORIENT", "SY(RCTLPT52, ORIENT)", "4", "O", "STANDARD", "25020"  
 "RDOCAL", "", "SY(RCLDEF01);TE('Nr %s', 'OBJNAM', 3, 2, 2, '15110', 1, -1, CHBLK, 21)", "6", "O", "STANDARD", "25060"  
 "RDOCAL", "TRAFIC1ORIENT", "SY(RDOCAL02, ORIENT);TE('Nr %s', 'OBJNAM', 3, 1, 2, '15110', 1, -1, CHBLK, 21);TE('ch %s', 'COMCHA', 3, 1, 2, '15110', 1, 1, CHBLK, 11)", "6", "O", "STANDARD", "25060"  
 "RDOCAL", "TRAFIC2ORIENT", "SY(RDOCAL02, ORIENT);TE('Nr %s', 'OBJNAM', 3, 1, 2, '15110', 1, -1, CHBLK, 21);TE('ch %s', 'COMCHA', 3, 1, 2, '15110', 1, 1, CHBLK, 11)", "6", "O", "STANDARD", "25060"  
 "RDOCAL", "TRAFIC3ORIENT", "SY(RDOCAL02, ORIENT);TE('Nr %s', 'OBJNAM', 3, 1, 2, '15110', 1, -1, CHBLK, 21);TE('ch %s', 'COMCHA', 3, 1, 2, '15110', 1, 1, CHBLK, 11)", "6", "O", "STANDARD", "25060"  
 "RDOCAL", "TRAFIC4ORIENT", "SY(RDOCAL03, ORIENT);TE('Nr %s', 'OBJNAM', 3, 1, 2, '15110', 1, -1, CHBLK, 21);TE('ch %s', 'COMCHA', 3, 1, 2, '15110', 1, 1, CHBLK, 11)", "6", "O", "STANDARD", "25060"  
 "RDOSTA", "", "SY(RDOSTA02)", "4", "O", "OTHER", "38010"  
 "RDOSTA", "CATROS10", "SY(DGPS04DRFSTA01)", "4", "O", "OTHER", "38010"  
 "RETRFL", "", "SY(RETRFL01)", "6", "O", "STANDARD", "27080"  
 "ROADWY", "", "", "", "", "", ""  
 "RSCSTA", "", "SY(RSCSTA02)", "7", "O", "OTHER", "38030"  
 "RTPBCN", "", "SY(RTPBCN02)", "6", "O", "STANDARD", "27210"  
 "RUNWAY", "", "", "", "", "", ""  
 "SBDARE", "", "TX(NATSUR, 1, 2, 2, '15110', 0, 0, CHBLK, 25)", "4", "O", "OTHER", "34010"  
 "SEAARE", "", "TX(OBJNAM, 1, 2, 3, '15110', 0, 0, CHBLK, 26)", "3", "S", "STANDARD", "21060"  
 "SILTNK", "", "SY(TNKCON02)", "4", "O", "OTHER", "32220"  
 "SILTNK", "CATSIL1CONVIS1", "SY(SILBUI11)", "4", "O", "STANDARD", "22220"  
 "SILTNK", "CATSIL2CONVIS1", "SY(TNKCON12)", "4", "O", "STANDARD", "22220"  
 "SILTNK", "CATSIL3CONVIS1", "SY(TOWERS03)", "4", "O", "STANDARD", "22220"  
 "SILTNK", "CATSIL4CONVIS1", "SY(TOWERS12)", "4", "O", "STANDARD", "22220"  
 "SILTNK", "CONVIS1", "SY(TNKCON12)", "4", "O", "STANDARD", "22220"  
 "SILTNK", "CATSIL1", "SY(SILBUI01)", "4", "O", "OTHER", "32220"  
 "SILTNK", "CATSIL2", "SY(TNKCON02)", "4", "O", "OTHER", "32220"

"SILTNK","CATSIL3","SY(TOWERS01)","4","O","OTHER","32220"  
 "SILTNK","CATSIL4","SY(TOWERS02)","4","O","OTHER","32220"  
 "SISTAT","SY(SISTAT02)","7","O","STANDARD","28020"  
 "SISTAW","SY(SISTAT02)","7","O","STANDARD","28020"  
 "SLCONS","SY(MORFAC03);CS(SLCONS03)","8","O","DISPLAYBASE","12410"  
 "SLOGRD","SY(HILTOP01)","3","S","OTHER","32010"  
 "SLOTOP","SY(HILTOP01)","3","S","OTHER","32010"  
 "SLOTOP","CONVIS1","SY(HILTOP11)","3","S","STANDARD","22220"  
 "SMCFAC","SY(SMCFAC02)","4","S","OTHER","38210"  
 "SNDWAV","SY(SNDWAV02)","4","O","STANDARD","24010"  
 "SOUNDG","CS(SOUNDG02)","6","O","OTHER","33010"  
 "SPLARE","SY(CHINFO06)","4","O","STANDARD","26040"  
 "SPRING","SY(SPRING02)","4","O","OTHER","34020"  
 "T\_HMON","SY(TIDEHT01)","4","O","OTHER","33050"  
 "T\_NHMN","SY(TIDEHT01)","4","O","OTHER","33050"  
 "T\_TIMS","SY(TIDEHT01)","4","O","OTHER","33050"  
 "TS\_FEB","SY(CURDEF01)","4","O","OTHER","33060"  
 "TS\_FEB","CAT\_TS1ORIENT","SY(FLDSTR01,ORIENT);TE('%4.1f kn','CURVEL',3,1,2,'15110',1,-1,CHBLK,31)","4","O","OTHER","33060"  
 "TS\_FEB","CAT\_TS2ORIENT","SY(EBBSTR01,ORIENT);TE('%4.1f kn','CURVEL',3,1,2,'15110',1,-1,CHBLK,31)","4","O","OTHER","33060"  
 "TS\_FEB","CAT\_TS3ORIENT","SY(CURRENT01,ORIENT);TE('%4.1f kn','CURVEL',3,1,2,'15110',1,-1,CHBLK,31)","4","O","OTHER","33060"  
 "TS\_PAD","SY(TIDSTR01)","4","O","OTHER","33060"  
 "TS\_PNH","SY(TIDSTR01)","4","O","OTHER","33060"  
 "TS\_PRH","SY(TIDSTR01)","4","O","OTHER","33060"  
 "TS\_TIS","SY(TIDSTR01)","4","O","OTHER","33060"  
 "TOPMAR","CS(TOPMAR01)","6","O","STANDARD","27050"  
 "TUNNEL","CS(OBSTRN06)","4","O","OTHER","34050"  
 "VEGATN","CATVEG7","SY(TREPNT05)","3","S","OTHER","32030"  
 "VEGATN","CATVEG21","SY(TREPNT05)","3","S","OTHER","32030"  
 "VEGATN","CATVEG3","SY(TREPNT04)","3","S","OTHER","32030"  
 "VEGATN","CATVEG4","SY(TREPNT04)","3","S","OTHER","32030"  
 "VEGATN","CATVEG5","SY(TREPNT04)","3","S","OTHER","32030"  
 "VEGATN","CATVEG6","SY(TREPNT04)","3","S","OTHER","32030"  
 "VEGATN","CATVEG13","SY(TREPNT04)","3","S","OTHER","32030"  
 "VEGATN","CATVEG14","SY(TREPNT04)","3","S","OTHER","32030"  
 "VEGATN","CATVEG15","SY(TREPNT04)","3","S","OTHER","32030"  
 "VEGATN","CATVEG16","SY(TREPNT04)","3","S","OTHER","32030"  
 "VEGATN","CATVEG17","SY(TREPNT04)","3","S","OTHER","32030"  
 "VEGATN","CATVEG18","SY(TREPNT04)","3","S","OTHER","32030"  
 "VEGATN","CATVEG19","SY(TREPNT04)","3","S","OTHER","32030"  
 "VEGATN","CATVEG20","SY(TREPNT04)","3","S","OTHER","32030"  
 "VEGATN","CATVEG22","SY(TREPNT04)","3","S","OTHER","32030"  
 "WATFAL","SY(WATTUR02)","3","O","OTHER","33040"  
 "WATTUR","SY(WATTUR02)","3","O","OTHER","33040"  
 "WEDKLP","SY(WEDKLP03)","3","O","OTHER","34020"  
 "WRECKS","CS(WRECKS04)","4","O","OTHER","34050"  
 "WRECKS","CATWRK3VALSOU","SY(FOULGND1)","4","O","OTHER","34051"





```
"vessel","CS(VESSEL02),"9","O","MARINERS STANDARD","54030"
"waypnt","SY(WAYPNT01);TX(OBJNAM,3,1,3,'15110',1,-1,APLRT,50),"8","O","DISPLAYBASE","42210"
"waypnt","select1","SY(WAYPNT01);TX(OBJNAM,3,1,3,'15110',1,-1,CHBLK,50),"8","O","DISPLAYBASE","42210"
"waypnt","select2","SY(WAYPNT03);TX(OBJNAM,3,1,3,'15110',1,-1,APLRT,50),"8","O","MARINERS STANDARD","52210"
*
* ***          ***
* *** end of look-up table ***
* ***          ***
```

### 11.1.2 Look-up Table for simplified point symbolisation

```
* *** SIMPLIFIED POINTS          ***
* *** This is the look-up table for point symbolization. ***
* *** For edition 3.4 Preslib, dated January 2008   *****
*
* Each line contains minimum 6 fields:
* 1. field - code of the object class
* 2. field - attribute combination
* 3. field - symbolization instruction
* 4. field - display priority
* 5. field - radar
* 6. field - IMO display category
* 7. field - viewing group (optional)
*
* Each field entry is framed by "" and fields are separated by '!'.
*
* Please note, that the entries to this table must be in
* alphabetic order (sorted by the class code).
*
* This table has 2 sections:
*
* - The first section contains symbolization instructions for
*   standard S-57 'real world' objects:
* - The second section contains symbolization instructions for
*   non-standard (class code in lowercase) objects:
*
* default for symbolization failure; must be the first entry to look-up table
*#####","SY(QUESMRK1),"5","O","STANDARD","21010"
*
```





"BOYSPP","BOYSHP1","SY(BOYSPP15);TE('by %s','OBJNAM',2,1,2,'15110',-1,-1,CHBLK,21)","8","O","STANDARD","27010"  
 "BOYSPP","BOYSHP2","SY(BOYSPP25);TE('by %s','OBJNAM',2,1,2,'15110',-1,-1,CHBLK,21)","8","O","STANDARD","27010"  
 "BOYSPP","BOYSHP3","SY(BOYSPP11);TE('by %s','OBJNAM',2,1,2,'15110',-1,-1,CHBLK,21)","8","O","STANDARD","27010"  
 "BOYSPP","BOYSHP4","SY(BOYSPP35);TE('by %s','OBJNAM',2,1,2,'15110',-1,-1,CHBLK,21)","8","O","STANDARD","27010"  
 "BOYSPP","BOYSHP5","SY(BOYSPP35);TE('by %s','OBJNAM',2,1,2,'15110',-1,-1,CHBLK,21)","8","O","STANDARD","27010"  
 "BOYSPP","BOYSHP6","SY(BOYSPP11);TE('by %s','OBJNAM',2,1,2,'15110',-1,-1,CHBLK,21)","8","O","STANDARD","27010"  
 "BOYSPP","BOYSHP7","SY(BOYSUP02);TE('by %s','OBJNAM',2,1,2,'15110',-1,-1,CHBLK,21)","8","O","STANDARD","27010"  
 "BOYSPP","BOYSHP8","SY(BOYSPP35);TE('by %s','OBJNAM',2,1,2,'15110',-1,-1,CHBLK,21)","8","O","STANDARD","27010"  
 "BRIDGE"," "," "," "," "," " "  
 "BUAARE"," ","SY(BUAARE02);TX(OBJNAM,3,2,2,'15110',1,0,CHBLK,26)","3","O","STANDARD","22240"  
 "BUISGL"," ","SY(BUISGL01)","4","O","OTHER","32220"  
 "BUISGL","FUNCTN33CONVIS1OBJNAM","SY(POSGEN03);TX(OBJNAM,3,2,2,'15110',1,0,CHBLK,26)","6","O","STANDARD","22220"  
 "BUISGL","FUNCTN20CONVIS1","SY(BUIREL13)","6","O","STANDARD","22220"  
 "BUISGL","FUNCTN21CONVIS1","SY(BUIREL13)","6","O","STANDARD","22220"  
 "BUISGL","FUNCTN22CONVIS1","SY(BUIREL14)","6","O","STANDARD","22220"  
 "BUISGL","FUNCTN23CONVIS1","SY(BUIREL14)","6","O","STANDARD","22220"  
 "BUISGL","FUNCTN24CONVIS1","SY(BUIREL14)","6","O","STANDARD","22220"  
 "BUISGL","FUNCTN25CONVIS1","SY(BUIREL14)","6","O","STANDARD","22220"  
 "BUISGL","FUNCTN26CONVIS1","SY(BUIREL15)","6","O","STANDARD","22220"  
 "BUISGL","FUNCTN27CONVIS1","SY(BUIREL15)","6","O","STANDARD","22220"  
 "BUISGL","FUNCTN33CONVIS1","SY(POSGEN03)","6","O","STANDARD","22220"  
 "BUISGL","FUNCTN35CONVIS1","SY(TNKCON12)","6","O","STANDARD","22220"  
 "BUISGL","FUNCTN33OBJNAM","SY(POSGEN03);TX(OBJNAM,3,2,2,'15110',1,0,CHBLK,26)","4","O","OTHER","32220"  
 "BUISGL","CONVIS1","SY(BUISGL11)","6","O","STANDARD","22220"  
 "BUISGL","FUNCTN20","SY(BUIREL01)","4","O","OTHER","32220"  
 "BUISGL","FUNCTN21","SY(BUIREL01)","4","O","OTHER","32220"  
 "BUISGL","FUNCTN22","SY(BUIREL04)","4","O","OTHER","32220"  
 "BUISGL","FUNCTN23","SY(BUIREL04)","4","O","OTHER","32220"  
 "BUISGL","FUNCTN24","SY(BUIREL04)","4","O","OTHER","32220"  
 "BUISGL","FUNCTN25","SY(BUIREL04)","4","O","OTHER","32220"  
 "BUISGL","FUNCTN26","SY(BUIREL05)","4","O","OTHER","32220"  
 "BUISGL","FUNCTN27","SY(BUIREL05)","4","O","OTHER","32220"  
 "BUISGL","FUNCTN33","SY(POSGEN03)","4","O","OTHER","32220"  
 "BUISGL","FUNCTN35","SY(TNKCON02)","4","O","OTHER","32220"  
 "CGUSTA"," ","SY(CGUSTA02)","7","O","OTHER","38030"  
**"CHKPNT"," ","SY(CHKPNT01)","4","S","OTHER","32410"**  
 "CRANES"," ","SY(CRANES01)","4","O","OTHER","32440"  
 "CTNARE"," ","SY(CHINFO06)","4","O","STANDARD","26050"  
 "CTRPNT"," ","SY(POSGEN04)","4","O","OTHER","32250"  
 "CTSARE"," ","SY(CHINFO07)","4","O","STANDARD","26250"  
**"CURENT"," ","SY(CURDEF01)","5","O","OTHER","33000"**  
 "CURENT","ORIENTCURVEL","SY(CURENT01,ORIENT);TE('%4.1f kn','CURVEL',3,1,2,'15110',1,-1,CHBLK,31)","5","O","OTHER","33060"  
 "CURENT","ORIENT","SY(CURENT01,ORIENT)","5","O","OTHER","33060"  
 "DAMCON"," ","SY(CATDAM3)","4","O","STANDARD","22010"  
 "DAYMAR"," ","SY(DAYSQR01);TE('bn %s','OBJNAM',2,1,2,'15110',-1,-1,CHBLK,21)","7","O","STANDARD","27025"  
 "DAYMAR","TOPSHP19","SY(DAYSQR01);TE('bn %s','OBJNAM',2,1,2,'15110',-1,-1,CHBLK,21)","7","O","STANDARD","27025"

"DAYMAR","TOPSHP20","SY(DAYSQR01);TE('bn %s','OBJNAM',2,1,2,'15110',-1,-1,CHBLK,21)","7","O","STANDARD","27025"  
 "DAYMAR","TOPSHP21","SY(DAYSQR01);TE('bn %s','OBJNAM',2,1,2,'15110',-1,-1,CHBLK,21)","7","O","STANDARD","27025"  
 "DAYMAR","TOPSHP24","SY(DAYTRIO1);TE('bn %s','OBJNAM',2,1,2,'15110',-1,-1,CHBLK,21)","7","O","STANDARD","27025"  
 "DAYMAR","TOPSHP25","SY(DAYTRIO5);TE('bn %s','OBJNAM',2,1,2,'15110',-1,-1,CHBLK,21)","7","O","STANDARD","27025"  
 "DISMAR","","SY(DISMAR03);TX(INFORM,2,1,2,'15110',2,0,CHBLK,21)","7","O","OTHER","32430"  
 "DISMAR","CATDIS1","SY(DISMAR04);TX(INFORM,2,1,2,'15110',2,0,CHBLK,21)","7","O","OTHER","32430"  
 "DMPGRD","","SY(CHINFO07)","4","O","STANDARD","26240"  
 "FOGSIG","","SY(FOGSIG01)","6","O","STANDARD","27080"  
 "FORSTC","","SY(FORSTC01)","4","O","OTHER","32220"  
 "FORSTC","CONVIS1","SY(FORSTC11)","4","O","STANDARD","22220"  
 "FSHFAC","","SY(FSHHAV01)","4","O","OTHER","34040"  
 "FSHFAC","CATFIF1","SY(FSHFAC03)","4","O","OTHER","34040"  
 "FSHFAC","CATFIF2","SY(FSHFAC02)","4","O","OTHER","34040"  
 "FSHFAC","CATFIF3","SY(FSHFAC02)","4","O","OTHER","34040"  
 "FSHFAC","CATFIF4","SY(FSHFAC02)","4","O","OTHER","34040"  
 "GATCON","","SY(GATCON04)","8","O","STANDARD","22010"  
 "GATCON","CATGAT2","SY(GATCON04)","8","O","STANDARD","22010"  
 "GATCON","CATGAT3","SY(GATCON04)","8","O","OTHER","32440"  
 "GATCON","CATGAT4","SY(GATCON03)","8","O","OTHER","32440"  
 "GRIDRN","","SY(CHINFO07)","4","O","OTHER","32410"  
 "HRBFAC","CATHAF1","SY(ROLROL01)","4","O","OTHER","32410"  
 "HRBFAC","CATHAF4","SY(HRBFAC09)","4","O","OTHER","32410"  
 "HRBFAC","CATHAF5","SY(SMCFAC02)","4","O","OTHER","32410"  
 "HULKES","","SY(HULKES01)","5","O","DISPLAYBASE","12410"  
 "ICNARE","","SY(CHINFO07)","4","O","STANDARD","26250"  
 "LIGHTS","","CS(LIGHTS05)","8","O","STANDARD","27070"  
 "LITFLT","","SY(LITFLT02);TE('by %s','OBJNAM',2,1,2,'15110',-1,-1,CHBLK,21)","8","O","STANDARD","27010"  
 "LITVES","","SY(LITVES02);TE('LIV %s','OBJNAM',2,1,2,'15110',-1,-1,CHBLK,21)","8","O","STANDARD","27011"  
 "LNDARE","","SY(LNDARE01);TX(OBJNAM,1,2,2,'15110',0,1,CHBLK,26);CS(QUAPOS01)","4","O","DISPLAYBASE","12010"  
 "LNDELV","","SY(POSGEN04);TE('%3.0lf m','ELEVAT',3,2,2,'15110',1,0,CHBLK,28)","4","O","OTHER","32010"  
 "LNDMRK","","SY(POSGEN01)","4","O","OTHER","32220"  
 "LNDMRK","CATLMK17FUNCTN33CONVIS1","SY(TOWERS03);TX(OBJNAM,3,2,2,'15110',1,-1,CHBLK,26)","6","O","STANDARD","22220"  
 "LNDMRK","CATLMK15FUNCTN20CONVIS1","SY(BUIREL13)","6","O","STANDARD","22220"  
 "LNDMRK","CATLMK15FUNCTN21CONVIS1","SY(BUIREL13)","6","O","STANDARD","22220"  
 "LNDMRK","CATLMK17FUNCTN20CONVIS1","SY(BUIREL13)","6","O","STANDARD","22220"  
 "LNDMRK","CATLMK17FUNCTN21CONVIS1","SY(BUIREL13)","6","O","STANDARD","22220"  
 "LNDMRK","CATLMK20FUNCTN20CONVIS1","SY(BUIREL13)","6","O","STANDARD","22220"  
 "LNDMRK","CATLMK20FUNCTN21CONVIS1","SY(BUIREL13)","6","O","STANDARD","22220"  
 "LNDMRK","CATLMK20FUNCTN26CONVIS1","SY(BUIREL15)","6","O","STANDARD","22220"  
 "LNDMRK","CATLMK20FUNCTN27CONVIS1","SY(BUIREL15)","6","O","STANDARD","22220"  
 "LNDMRK","CATLMK17FUNCTN33","SY(TOWERS01);TX(OBJNAM,3,2,2,'15110',1,-1,CHBLK,26)","4","O","OTHER","32220"  
 "LNDMRK","CATLMK1CONVIS1","SY(CAIRNS11)","6","O","STANDARD","22220"  
 "LNDMRK","CATLMK3CONVIS1","SY(CHIMNY11)","6","O","STANDARD","22220"  
 "LNDMRK","CATLMK4CONVIS1","SY(DSHAER11)","6","O","STANDARD","22220"  
 "LNDMRK","CATLMK5CONVIS1","SY(FLGSTF01)","6","O","STANDARD","22220"  
 "LNDMRK","CATLMK6CONVIS1","SY(FLASTK11)","6","O","STANDARD","22220"  
 "LNDMRK","CATLMK7CONVIS1","SY(MSTCON14)","6","O","STANDARD","22220"  
 "LNDMRK","CATLMK8CONVIS1","SY(POSGEN03)","6","O","STANDARD","22220"

"LNDMRK","CATLMK9CONVIS1","SY(MONUMT12)","6","O","STANDARD","22220"  
 "LNDMRK","CATLMK10CONVIS1","SY(MONUMT12)","6","O","STANDARD","22220"  
 "LNDMRK","CATLMK12CONVIS1","SY(MONUMT12)","6","O","STANDARD","22220"  
 "LNDMRK","CATLMK13CONVIS1","SY(MONUMT12)","6","O","STANDARD","22220"  
 "LNDMRK","CATLMK15CONVIS1","SY(DOMES011)","6","O","STANDARD","22220"  
 "LNDMRK","CATLMK16CONVIS1","SY(RASCAN11)","6","O","STANDARD","22220"  
 "LNDMRK","CATLMK17CONVIS1","SY(TOWERS03)","6","O","STANDARD","22220"  
 "LNDMRK","CATLMK18CONVIS1","SY(WNDMIL12)","6","O","STANDARD","22220"  
 "LNDMRK","CATLMK19CONVIS1","SY(WIMCON11)","6","O","STANDARD","22220"  
 "LNDMRK","CATLMK20CONVIS1","SY(POSGEN03)","6","O","STANDARD","22220"  
 "LNDMRK","CATLMK15FUNCTN20","SY(BUIREL01)","4","O","OTHER","32220"  
 "LNDMRK","CATLMK17FUNCTN20","SY(BUIREL01)","4","O","OTHER","32220"  
 "LNDMRK","CATLMK20FUNCTN20","SY(BUIREL01)","4","O","OTHER","32220"  
 "LNDMRK","CATLMK3","SY(CHIMNY01)","4","O","OTHER","32220"  
 "LNDMRK","CATLMK6","SY(FLASTK01)","4","O","OTHER","32220"  
 "LNDMRK","CATLMK7","SY(MSTCON04)","4","O","OTHER","32220"  
 "LNDMRK","CATLMK15","SY(DOMES001)","4","O","OTHER","32220"  
 "LNDMRK","CATLMK16","SY(RASCAN01)","4","O","OTHER","32220"  
 "LNDMRK","CATLMK17","SY(TOWERS01)","4","O","OTHER","32220"  
 "LNDMRK","CONVIS1","SY(POSGEN03)","6","O","STANDARD","22220"  
 "LNDRGN","","SY(POSGEN04);TX(OBJNAM,1,2,2,'15110',0,-1,CHBLK,26),"4","O","STANDARD","21060"  
 "LOCMAG","","SY(LOCMAG01)","4","O","OTHER","31080"  
 "LOGPON","","SY(FLTHAZ02)","4","O","OTHER","34050"  
 "M\_NPUB","","SY(CHINFO07)","4","O","OTHER","31020"  
 "MAGVAR","","SY(MAGVAR01);TX(VALMAG,3,1,2,'15110',1,-1,CHBLK,27),"4","O","OTHER","31080"  
 "MARCUL","","SY(MARCUL02)","4","O","STANDARD","26210"  
 "MIPARE","","SY(CHINFO06)","4","O","STANDARD","26040"  
 "MORFAC","","SY(MORFAC03)","6","O","DISPLAYBASE","12410"  
 "MORFAC","CATMOR1","SY(MORFAC03)","6","O","DISPLAYBASE","12410"  
 "MORFAC","CATMOR2","SY(MORFAC04)","6","O","DISPLAYBASE","12410"  
 "MORFAC","CATMOR3","SY(PILPNT02)","6","O","OTHER","32440"  
 "MORFAC","CATMOR5","SY(PILPNT02)","6","O","DISPLAYBASE","12410"  
 "MORFAC","CATMOR7","SY(BOYMOR11)","8","O","STANDARD","27010"  
 "NEWOBJ","","SY(NEWOBJ 01)","6","S","STANDARD","21020"  
 "NEWOBJ","SYMINS","CS(SYMINS01)","6","S","STANDARD","21020"  
 "OBSTRN","","CS(OBSTRN06)","4","O","OTHER","34050"  
 "OBSTRN","CATOBS7VALSOU","SY(FOULGND1)","4","O","OTHER","34051"  
 "OBSTRN","CATOBS8VALSOU","SY(FLTHAZ02)","4","O","OTHER","34051"  
 "OBSTRN","CATOBS9VALSOU","SY(ACHARE02)","4","O","OTHER","34051"  
 "OBSTRN","CATOBS10VALSOU","SY(FLTHAZ02)","4","O","OTHER","34051"  
 "OBSTRN","CATOBS7","SY(FOULGND1)","4","O","OTHER","34050"  
 "OBSTRN","CATOBS8","SY(FLTHAZ02)","4","O","OTHER","34050"  
 "OBSTRN","CATOBS9","SY(ACHARE02)","4","O","OTHER","34050"  
 "OBSTRN","CATOBS10","SY(FLTHAZ02)","4","O","OTHER","34050"  
 "OBSTRN","WATLEV7","SY(FLTHAZ02)","4","O","DISPLAYBASE","12410"  
 "OFSPLF","","SY(OFSPLF01);TE('Prod %s',OBJNAM,3,1,2,'15110',1,-1,CHBLK,21),"5","O","DISPLAYBASE","12210"  
 "PILBOP","","SY(PILBOP02);TE('Plt %s',OBJNAM,3,1,2,'15110',1,-1,CHBLK,21),"6","O","STANDARD","28010"  
 "PILPNT","","SY(PILPNT02)","5","O","DISPLAYBASE","12410"  
 "PIPAE","","SY(CHINFO07)","4","O","STANDARD","26230"

"PIPSOL", "", "", "", "", "", ""  
 "PRCARE", "", "SY(PRCARE12)", "5", "O", "STANDARD", "25010"  
 "PRDARE", "", "", "", "", "", ""  
 "PRDARE", "CATPRA5CONVIS1", "SY(FLASTK11)", "4", "O", "STANDARD", "22220"  
 "PRDARE", "CATPRA8CONVIS1", "SY(TNKCON12)", "4", "O", "STANDARD", "22220"  
 "PRDARE", "CATPRA9CONVIS1", "SY(WIMCON11)", "4", "O", "STANDARD", "22220"  
 "PRDARE", "CATPRA1", "SY(PRDINS02)", "34", "O", "OTHER", "32270"  
 "PRDARE", "CATPRA2", "SY(PRDINS02)", "4", "O", "OTHER", "32270"  
 "PRDARE", "CATPRA3", "SY(PRDINS02)", "4", "O", "OTHER", "32270"  
 "PRDARE", "CATPRA4", "SY(PRDINS02)", "4", "O", "OTHER", "32270"  
 "PRDARE", "CATPRA5", "SY(FLASTK01)", "34", "O", "OTHER", "32270"  
 "PRDARE", "CATPRA6", "SY(TMBYRD01)", "34", "O", "OTHER", "32270"  
 "PRDARE", "CATPRA7", "SY(PRDINS02)", "4", "O", "OTHER", "32270"  
 "PRDARE", "CATPRA8", "SY(TNKCON02)", "34", "O", "OTHER", "32270"  
 "PRDARE", "CATPRA9", "SY(WIMCON01)", "34", "O", "OTHER", "32270"  
 "PRDARE", "CATPRA10", "SY(PRDINS02)", "4", "O", "OTHER", "32270"  
 "PYLONS", "", "SY(POSGEN03)", "8", "O", "DISPLAYBASE", "12210"  
 "RADRFL", "", "SY(RADRFL03)", "6", "O", "STANDARD", "27230"  
 "RADSTA", "", "SY(POSGEN01)", "5", "O", "OTHER", "38010"  
 "RADSTA", "CATRAS2", "SY(RDOSTA02);TE('ch %s', 'COMCHA', 3, 1, 2, '15110', 0, 0, CHBLK, 11)", "5", "O", "OTHER", "38010"  
 "RAPIDS", "", "", "", "", "", ""  
 "RCTLPT", "", "SY(RTLDEF51)", "4", "O", "STANDARD", "25020"  
 "RCTLPT", "ORIENT", "SY(RCTLPT52, ORIENT)", "4", "O", "STANDARD", "25020"  
 "RDOCAL", "", "SY(RCLDEF01);TE('Nr %s', 'OBJNAM', 3, 2, 2, '15110', 1, -1, CHBLK, 21)", "6", "O", "STANDARD", "25060"  
 "RDOCAL", "TRAFIC1ORIENT", "SY(RDOCAL02, ORIENT);TE('Nr %s', 'OBJNAM', 3, 1, 2, '15110', 1, -1, CHBLK, 21);TE('ch %s', 'COMCHA', 3, 1, 2, '15110', 1, 1, CHBLK, 11)", "6", "O", "STANDARD", "25060"  
 "RDOCAL", "TRAFIC2ORIENT", "SY(RDOCAL02, ORIENT);TE('Nr %s', 'OBJNAM', 3, 1, 2, '15110', 1, -1, CHBLK, 21);TE('ch %s', 'COMCHA', 3, 1, 2, '15110', 1, 1, CHBLK, 11)", "6", "O", "STANDARD", "25060"  
 "RDOCAL", "TRAFIC3ORIENT", "SY(RDOCAL02, ORIENT);TE('Nr %s', 'OBJNAM', 3, 1, 2, '15110', 1, -1, CHBLK, 21);TE('ch %s', 'COMCHA', 3, 1, 2, '15110', 1, 1, CHBLK, 11)", "6", "O", "STANDARD", "25060"  
 "RDOCAL", "TRAFIC4ORIENT", "SY(RDOCAL03, ORIENT);TE('Nr %s', 'OBJNAM', 3, 1, 2, '15110', 1, -1, CHBLK, 21);TE('ch %s', 'COMCHA', 3, 1, 2, '15110', 1, 1, CHBLK, 11)", "6", "O", "STANDARD", "25060"  
 "RDOSTA", "", "SY(RDOSTA02)", "4", "O", "OTHER", "38010"  
 "RDOSTA", "CATROS10", "SY(DGPS04DRFSTA01)", "4", "O", "OTHER", "38010"  
 "RETRFL", "", "SY(RETRFL02)", "6", "O", "STANDARD", "27080"  
 "ROADWY", "", "", "", "", "", ""  
 "RSCSTA", "", "SY(RSCSTA02)", "7", "O", "OTHER", "38030"  
 "RTPBCN", "", "SY(RTPBCN02)", "6", "O", "STANDARD", "27210"  
 "RUNWAY", "", "", "", "", "", ""  
 "SBDARE", "", "TX(NATSUR, 1, 2, 2, '15110', 0, 0, CHBLK, 25)", "4", "O", "OTHER", "34010"  
 "SEAARE", "", "TX(OBJNAM, 1, 2, 3, '15110', 0, 0, CHBLK, 26)", "3", "S", "STANDARD", "21060"  
 "SILTNK", "", "SY(TNKCON02)", "4", "O", "OTHER", "32220"  
 "SILTNK", "CATSIL1CONVIS1", "SY(SILBUI11)", "4", "O", "STANDARD", "22220"  
 "SILTNK", "CATSIL2CONVIS1", "SY(TNKCON12)", "4", "O", "STANDARD", "22220"  
 "SILTNK", "CATSIL3CONVIS1", "SY(TOWERS03)", "4", "O", "STANDARD", "22220"  
 "SILTNK", "CATSIL4CONVIS1", "SY(TOWERS12)", "4", "O", "STANDARD", "22220"  
 "SILTNK", "CONVIS1", "SY(TNKCON12)", "4", "O", "STANDARD", "22220"  
 "SILTNK", "CATSIL1", "SY(SILBUI01)", "4", "O", "OTHER", "32220"  
 "SILTNK", "CATSIL2", "SY(TNKCON02)", "4", "O", "OTHER", "32220"



"SILTNN", "CATSIL3", "SY(TOWERS01)", "4", "O", "OTHER", "32220"  
 "SILTNN", "CATSIL4", "SY(TOWERS02)", "4", "O", "OTHER", "32220"  
 "SISTAT", "", "SY(SISTAT02)", "7", "O", "STANDARD", "28020"  
 "SISTAW", "", "SY(SISTAT02)", "7", "O", "STANDARD", "28020"  
 "SLCONS", "", "SY(MORFAC03);CS(SLCONS03)", "8", "O", "DISPLAYBASE", "12410"  
 "SLOGRD", "", "SY(HILTOP01)", "3", "S", "OTHER", "32010"  
 "SLOTOP", "", "SY(HILTOP01)", "3", "S", "OTHER", "32010"  
 "SLOTOP", "CONVIS1", "SY(HILTOP11)", "3", "S", "STANDARD", "22220"  
 "SMCFAC", "", "", "", "", "", "", "", "", "", ""  
**"SMCFAC", "", "SY(SMCFAC02)", "4", "S", "OTHER", "38210"**  
 "SNDWAV", "", "SY(SNDWAV02)", "4", "O", "STANDARD", "24010"  
 "SOUNDG", "", "CS(SOUNDG02)", "6", "O", "OTHER", "33010"  
 "SPLARE", "", "SY(CHINFO06)", "4", "O", "STANDARD", "26040"  
 "SPRING", "", "SY(SPRING02)", "4", "O", "OTHER", "34020"  
 "T\_HMON", "", "SY(TIDEHT01)", "4", "O", "OTHER", "33050"  
 "T\_NHMN", "", "SY(TIDEHT01)", "4", "O", "OTHER", "33050"  
 "T\_TIMS", "", "SY(TIDEHT01)", "4", "O", "OTHER", "33050"  
 "TS\_FEB", "", "SY(CURDEF01)", "4", "O", "OTHER", "33060"  
 "TS\_FEB", "CAT\_TS1ORIENT", "SY(FLDSTR01,ORIENT);TE('%4.1lf kn',CURVEL',3,1,2,'15110',1,-1,CHBLK,31)", "4", "O", "OTHER", "33060"  
 "TS\_FEB", "CAT\_TS2ORIENT", "SY(EBBSTR01,ORIENT);TE('%4.1lf kn',CURVEL',3,1,2,'15110',1,-1,CHBLK,31)", "4", "O", "OTHER", "33060"  
 "TS\_FEB", "CAT\_TS3ORIENT", "SY(CURRENT01,ORIENT);TE('%4.1lf kn',CURVEL',3,1,2,'15110',1,-1,CHBLK,31)", "4", "O", "OTHER", "33060"  
 "TS\_PAD", "", "SY(TIDSTR01)", "4", "O", "OTHER", "33060"  
 "TS\_PNH", "", "SY(TIDSTR01)", "4", "O", "OTHER", "33060"  
 "TS\_PRH", "", "SY(TIDSTR01)", "4", "O", "OTHER", "33060"  
 "TS\_TIS", "", "SY(TIDSTR01)", "4", "O", "OTHER", "33060"  
 "TOPMAR", "", "", "", "", "", "", "", "", "", ""  
 "TUNNEL", "", "", "", "", "", "", "", "", "", ""  
 "UWTROC", "", "CS(OBSTRN06)", "4", "O", "OTHER", "34050"  
 "VEGATN", "", "", "", "", "", "", "", "", "", ""  
**"VEGATN", "CATVEG7", "SY(TREPNT05)", "3", "S", "OTHER", "32030"**  
**"VEGATN", "CATVEG21", "SY(TREPNT05)", "3", "S", "OTHER", "32030"**  
**"VEGATN", "CATVEG3", "SY(TREPNT04)", "3", "S", "OTHER", "32030"**  
**"VEGATN", "CATVEG4", "SY(TREPNT04)", "3", "S", "OTHER", "32030"**  
**"VEGATN", "CATVEG5", "SY(TREPNT04)", "3", "S", "OTHER", "32030"**  
**"VEGATN", "CATVEG6", "SY(TREPNT04)", "3", "S", "OTHER", "32030"**  
**"VEGATN", "CATVEG13", "SY(TREPNT04)", "3", "S", "OTHER", "32030"**  
**"VEGATN", "CATVEG14", "SY(TREPNT04)", "3", "S", "OTHER", "32030"**  
**"VEGATN", "CATVEG15", "SY(TREPNT04)", "3", "S", "OTHER", "32030"**  
**"VEGATN", "CATVEG16", "SY(TREPNT04)", "3", "S", "OTHER", "32030"**  
**"VEGATN", "CATVEG17", "SY(TREPNT04)", "3", "S", "OTHER", "32030"**  
**"VEGATN", "CATVEG18", "SY(TREPNT04)", "3", "S", "OTHER", "32030"**  
**"VEGATN", "CATVEG19", "SY(TREPNT04)", "3", "S", "OTHER", "32030"**  
**"VEGATN", "CATVEG20", "SY(TREPNT04)", "3", "S", "OTHER", "32030"**  
**"VEGATN", "CATVEG22", "SY(TREPNT04)", "3", "S", "OTHER", "32030"**  
 "WATFAL", "", "", "", "", "", "", "", "", "", ""  
 "WATTUR", "", "SY(WATTUR02)", "3", "O", "OTHER", "33040"  
 "WEDKLP", "", "SY(WEDKLP03)", "3", "O", "OTHER", "34020"  
 "WRECKS", "", "CS(WRECKS04)", "4", "O", "OTHER", "34050"  
 "WRECKS", "CATWRK3VALSOU", "SY(FOULGND1)", "4", "O", "OTHER", "34051"

"WRECKS","CATWRK3","SY(FOULGND1)","4","O","OTHER","34050"

\*

\* \*\*\* \*\*\*

\* \*\*\* section two: NON-STANDARD CLASSES \*\*\*

\* \*\*\* \*\*\*

\*

\*Note: category "DISPLAYBASE" should not be removed from the display.

\*For non-standard classes, all category "MARINERS STANDARD" and "MARINERS OTHER"

\*should be drawn when "STANDARD DISPLAY" is drawn, and thereafter may be re-assigned

\*to the category of chosen by the mariner.

\*

"cursor","SY(CURSRA01)","8","O","DISPLAYBASE","11010"

"cursor","cursty2","SY(CURSRB01)","8","O","MARINERS OTHER","61040"

"dnghlt","SY(DNGHILIT)","8","O","MARINERS STANDARD","53010"

"events","SY(EVENTS03);TX(OBJNAM,3,2,3,'15110',1,0,CHBLK,50)","8","O","MARINERS STANDARD","52410"

"marfea","SY(CHINFO09);TX(OBJNAM,3,1,3,'15110',1,-1,CHBLK,50)","8","O","MARINERS STANDARD","53050"

"marnot","SY(CHINFO09);TX(usrmrk,3,1,2,'15110',0,0,CHBLK,50)","8","O","MARINERS STANDARD","53040"

"marnot","catnot1","SY(CHINFO08);TX(usrmrk,3,1,2,'15110',0,0,CHBLK,50)","8","O","MARINERS STANDARD","53030"

"marnot","catnot2","SY(CHINFO09);TX(usrmrk,3,1,2,'15110',0,0,CHBLK,50)","8","O","MARINERS STANDARD","53040"

"mnufea","SY(CHINFO10)","5","O","MARINERS STANDARD","55010"

"mnufea","catnot1","SY(CHINFO10)","5","O","MARINERS STANDARD","55010"

"mnufea","catnot2","SY(CHINFO11)","5","O","MARINERS STANDARD","55020"

"ownshp","CS(OWNSHP02)","9","O","DISPLAYBASE","42010"

"plnpos","SY(PLNPOS01);SY(PLNPOS02,ORIENT);TX(plndat,1,2,2,'15110',4,3,CHBLK,50)","5","O","MARINERS STANDARD","52030"

"positn","SY(POSITN02);TX(loctim,1,1,2,'15110',0,-1,CHBLK,50)","5","O","MARINERS OTHER","62010"

"positn","pfmeth1","SY(POSITN02);TX('DR',2,3,2,'15110',-1,1,CHBLK,50);TX(loctim,1,1,2,'15110',0,-1,CHBLK,50)","5","O","MARINERS OTHER","62010"

"positn","pfmeth2","SY(POSITN02);TX('EP',2,3,2,'15110',-1,1,CHBLK,50);TX(loctim,1,1,2,'15110',0,-1,CHBLK,50)","5","O","MARINERS OTHER","62010"

"positn","pfmeth3","SY(POSITN02);TX('V',3,3,2,'15110',1,1,CHBLK,50);TX(loctim,1,1,2,'15110',0,-1,CHBLK,50)","5","O","MARINERS OTHER","62010"

"positn","pfmeth4","SY(POSITN02);TX('A',3,3,2,'15110',1,1,CHBLK,50);TX(loctim,1,1,2,'15110',0,-1,CHBLK,50)","5","O","MARINERS OTHER","62010"

"positn","pfmeth5","SY(POSITN02);TX('R',3,3,2,'15110',1,1,CHBLK,50);TX(loctim,1,1,2,'15110',0,-1,CHBLK,50)","5","O","MARINERS OTHER","62010"

"positn","pfmeth6","SY(POSITN02);TX('D',3,3,2,'15110',1,1,CHBLK,50);TX(loctim,1,1,2,'15110',0,-1,CHBLK,50)","5","O","MARINERS OTHER","62010"

"positn","pfmeth7","SY(POSITN02);TX('G',3,3,2,'15110',1,1,CHBLK,50);TX(loctim,1,1,2,'15110',0,-1,CHBLK,50)","5","O","MARINERS OTHER","62010"

"positn","pfmeth8","SY(POSITN02);TX('GI',3,3,2,'15110',1,1,CHBLK,50);TX(loctim,1,1,2,'15110',0,-1,CHBLK,50)","5","O","MARINERS OTHER","62010"

"positn","pfmeth9","SY(POSITN02);TX('L',3,3,2,'15110',1,1,CHBLK,50);TX(loctim,1,1,2,'15110',0,-1,CHBLK,50)","5","O","MARINERS OTHER","62010"

"positn","pfmeth10","SY(POSITN02);TX('M',3,3,2,'15110',1,1,CHBLK,50);TX(loctim,1,1,2,'15110',0,-1,CHBLK,50)","5","O","MARINERS OTHER","62010"

"positn","pfmeth11","SY(POSITN02);TX('O',3,3,2,'15110',1,1,CHBLK,50);TX(loctim,1,1,2,'15110',0,-1,CHBLK,50)","5","O","MARINERS OTHER","62010"

"positn","pfmeth12","SY(POSITN02);TX('T',3,3,2,'15110',1,1,CHBLK,50);TX(loctim,1,1,2,'15110',0,-1,CHBLK,50)","5","O","MARINERS OTHER","62010"

"positn","pfmeth13","SY(POSITN02);TX('dG',3,3,2,'15110',1,1,CHBLK,50);TX(loctim,1,1,2,'15110',0,-1,CHBLK,50)","5","O","MARINERS OTHER","62010"

"positn","pfmeth14","SY(POSITN02);TX('dGI',3,3,2,'15110',1,1,CHBLK,50);TX(loctim,1,1,2,'15110',0,-1,CHBLK,50)","5","O","MARINERS OTHER","62010"

"positn","pfmeth15","SY(POSITN02);TX('dO',3,3,2,'15110',1,1,CHBLK,50);TX(loctim,1,1,2,'15110',0,-1,CHBLK,50)","5","O","MARINERS OTHER","62010"

"refpnt","SY(REFPNT02)","7","O","MARINERS OTHER","61050"

"tidcur","SY(TIDCUR01,ORIENT);SY(TIDCUR03);TX(curstr,2,3,2,'15110',-1,2,CHBLK,50);TX(loctim,3,1,2,'15110',1,-2,CHBLK,50)","7","O","MARINERS STANDARD","53080"

"tidcur","catcur1","SY(TIDCUR01,ORIENT);SY(TIDCUR03);TX('P',2,3,2,'15110',-4,2,CHBLK,50);TX(curstr,2,3,2,'15110',-1,2,CHBLK,50);TX(loctim,3,1,2,'15110',1,-2,CHBLK,50)","7","O","MARINERS STANDARD","53080"

"tidcur","catcur2","SY(TIDCUR02,ORIENT);SY(TIDCUR03);TX('A',2,3,2,'15110',-4,2,CHBLK,50);TX(curstr,2,3,2,'15110',-1,2,CHBLK,50);TX(loctim,3,1,2,'15110',1,-2,CHBLK,50)","7","O","MARINERS STANDARD","53080"

```
"vessel","CS(VESSEL02),"9","O","MARINERS STANDARD","54030"
"waypnt","SY(WAYPNT01);TX(OBJNAM,3,1,3,'15110',1,-1,APLRT,50),"8","O","DISPLAYBASE","42210"
"waypnt","select1","SY(WAYPNT01);TX(OBJNAM,3,1,3,'15110',1,-1,CHBLK,50),"8","O","DISPLAYBASE","42210"
"waypnt","select2","SY(WAYPNT03);TX(OBJNAM,3,1,3,'15110',1,-1,APLRT,50),"8","O","MARINERS STANDARD","52210"
*
* ***          ***
* *** end of look-up table ***
* ***          ***
```

## 11.2 Look-up Table Listing for Object Type Line 'L'

```
* *** LINES          ***
* *** This is the look-up table for line symbolization. ***
* *** For edition 3.4 Preslib, dated January 2008   *****
*
* Each line contains minimum 6 fields:
* 1. field - code of the object class
* 2. field - attribute combination
* 3. field - symbolization instruction
* 4. field - display priority
* 5. field - radar
* 6. field - IMO display category
* 7. field - viewing group (optional)
*
* Each field entry is framed by "" and fields are separated by ','.
*
* Please note, that the entries to this table must be in
* alphabetic order (sorted by the class code).
*
* This table has 2 sections:
*
* - The first section contains symbolization instructions for
*   standard S-57 'real world' objects:
* - The second section contains symbolization instructions for
*   non-standard (class code in lowercase) objects:
*
* default for symbolization failure; must be the first entry to look-up table
*#####","LC(QUESMRK1),"5","O","STANDARD","21010"
*
```

```

***
***
* *** section one: REAL WORLD CLASSES ***
***
*
"ASLXIS", "", "LS(DASH,2,CHMGF)", "5", "S", "STANDARD", "26260"
"BERTHS", "", "LS(SOLD,3,CHGRD);SY(BRTHNO01);TE('Nr %s', 'OBJNAM', 1,2,2, '15110', 0,0, CHBLK, 29)", "5", "O", "OTHER", "32440"
"BRIDGE", "", "LS(SOLD,5,CHGRD);TX(OBJNAM,3,1,2, '15110', 1,0, CHBLK, 21);TE('clr %4.1lf', 'VERCLR', 3,1,2, '15110', 1,1, CHBLK, 11)", "8", "O", "DISPLAYBASE", "12210"
"BRIDGE", "CATBRG2", "LS(SOLD,5,CHGRD);SY(BRIDGE01);TE('clr cl %4.1lf', 'VERCCL', 3,1,2, '15110', 1,0, CHBLK, 11);TE('clr op %4.1lf', 'VERCOP', 3,1,2, '15110', 1,1, CHBLK, 11)", "8", "O", "DISPLAYBASE", "12210"
"BRIDGE", "CATBRG3", "LS(SOLD,5,CHGRD);SY(BRIDGE01);TE('clr cl %4.1lf', 'VERCCL', 3,1,2, '15110', 1,0, CHBLK, 11);TE('clr op %4.1lf', 'VERCOP', 3,1,2, '15110', 1,1, CHBLK, 11)", "8", "O", "DISPLAYBASE", "12210"
"BRIDGE", "CATBRG4", "LS(SOLD,5,CHGRD);SY(BRIDGE01);TE('clr cl %4.1lf', 'VERCCL', 3,1,2, '15110', 1,0, CHBLK, 11);TE('clr op %4.1lf', 'VERCOP', 3,1,2, '15110', 1,1, CHBLK, 11)", "8", "O", "DISPLAYBASE", "12210"
"BRIDGE", "CATBRG5", "LS(SOLD,5,CHGRD);SY(BRIDGE01);TE('clr cl %4.1lf', 'VERCCL', 3,1,2, '15110', 1,0, CHBLK, 11);TE('clr op %4.1lf', 'VERCOP', 3,1,2, '15110', 1,1, CHBLK, 11)", "8", "O", "DISPLAYBASE", "12210"
"BRIDGE", "CATBRG7", "LS(SOLD,5,CHGRD);SY(BRIDGE01);TE('clr cl %4.1lf', 'VERCCL', 3,1,2, '15110', 1,0, CHBLK, 11);TE('clr op %4.1lf', 'VERCOP', 3,1,2, '15110', 1,1, CHBLK, 11)", "8", "O", "DISPLAYBASE", "12210"
"BRIDGE", "CATBRG8", "LS(SOLD,5,CHGRD);SY(BRIDGE01);TE('clr cl %4.1lf', 'VERCCL', 3,1,2, '15110', 1,0, CHBLK, 11);TE('clr op %4.1lf', 'VERCOP', 3,1,2, '15110', 1,1, CHBLK, 11)", "8", "O", "DISPLAYBASE", "12210"
"CANALS", "", "LS(SOLD,1,CHBLK)", "2", "O", "DISPLAYBASE", "12420"
"CAUSWY", "", "LS(SOLD,3,LANDF)", "5", "O", "STANDARD", "22010"
"CAUSWY", "WATLEV4", "LS(DASH,3,LANDF)", "5", "O", "STANDARD", "22010"
"CBLOHD", "", "LS(DASH,4,CHGRD)", "8", "O", "DISPLAYBASE", "12210"
"CBLOHD", "CONRAD1VERCSA", "LS(DASH,4,CHGRD);SY(RACNSP01);TE('sf clr %4.1lf', 'VERCSA', 3,1,2, '15110', 1,0, CHBLK, 11)", "8", "O", "DISPLAYBASE", "12210"
"CBLOHD", "CONRAD3VERCSA", "LS(DASH,4,CHGRD);SY(RACNSP01);TE('sf clr %4.1lf', 'VERCSA', 3,1,2, '15110', 1,0, CHBLK, 11)", "8", "O", "DISPLAYBASE", "12210"
"CBLOHD", "CONRAD1VERCLR", "LS(DASH,4,CHGRD);SY(RACNSP01);TE('clr %4.1lf', 'VERCLR', 3,1,2, '15110', 1,0, CHBLK, 11)", "8", "O", "DISPLAYBASE", "12210"
"CBLOHD", "CONRAD3VERCLR", "LS(DASH,4,CHGRD);SY(RACNSP01);TE('clr %4.1lf', 'VERCLR', 3,1,2, '15110', 1,0, CHBLK, 11)", "8", "O", "DISPLAYBASE", "12210"
"CBLOHD", "CONRAD1", "LS(DASH,4,CHGRD);SY(RACNSP01)", "8", "O", "DISPLAYBASE", "12210"
"CBLOHD", "CONRAD3", "LS(DASH,4,CHGRD);SY(RACNSP01)", "8", "O", "DISPLAYBASE", "12210"
"CBLOHD", "VERCSA", "LS(DASH,4,CHGRD);TE('sf clr %4.1lf', 'VERCSA', 3,1,2, '15110', 1,0, CHBLK, 11)", "8", "O", "DISPLAYBASE", "12210"
"CBLOHD", "VERCLR", "LS(DASH,4,CHGRD);TE('clr %4.1lf', 'VERCLR', 3,1,2, '15110', 1,0, CHBLK, 11)", "8", "O", "DISPLAYBASE", "12210"
"CBLSUB", "", "LC(CBLSUB06)", "3", "O", "OTHER", "34070"
"CBLSUB", "CATCBL6", "LS(DASH,1,CHMGD)", "6", "O", "STANDARD", "24010"
"COALNE", "", "CS(QUAPOS01)", "7", "O", "DISPLAYBASE", "12410"
"COALNE", "CATCOA6", "LS(DASH,1,CSTLN)", "7", "O", "DISPLAYBASE", "12410"
"COALNE", "CATCOA7", "LS(DASH,1,CSTLN)", "7", "O", "DISPLAYBASE", "12410"
"COALNE", "CATCOA8", "LS(DASH,1,CSTLN)", "7", "O", "DISPLAYBASE", "12410"
"COALNE", "CATCOA10", "LS(DASH,1,CSTLN)", "7", "O", "DISPLAYBASE", "12410"
"CONVYR", "", "LS(DASH,4,CHGRD);TE('clr %4.1lf', 'VERCLR', 3,1,2, '15110', 1,0, CHBLK, 11)", "8", "O", "DISPLAYBASE", "12210"
"CONVYR", "CATCON1CONRAD1", "LS(DASH,4,CHGRD);SY(RACNSP01);TE('clr %4.1lf', 'VERCLR', 3,1,2, '15110', 1,0, CHBLK, 11)", "8", "O", "DISPLAYBASE", "12210"
"CONVYR", "CATCON1CONRAD3", "LS(DASH,4,CHGRD);SY(RACNSP01);TE('clr %4.1lf', 'VERCLR', 3,1,2, '15110', 1,0, CHBLK, 11)", "8", "O", "DISPLAYBASE", "12210"
"CONVYR", "CATCON2CONRAD1", "LS(SOLD,3,CHGRD);SY(RACNSP01);TE('clr %4.1lf', 'VERCLR', 3,1,2, '15110', 1,0, CHBLK, 11)", "8", "O", "DISPLAYBASE", "12210"
"CONVYR", "CATCON2CONRAD3", "LS(SOLD,3,CHGRD);SY(RACNSP01);TE('clr %4.1lf', 'VERCLR', 3,1,2, '15110', 1,0, CHBLK, 11)", "8", "O", "DISPLAYBASE", "12210"
"CONVYR", "CATCON1", "LS(DASH,4,CHGRD);TE('clr %4.1lf', 'VERCLR', 3,1,2, '15110', 1,0, CHBLK, 11)", "8", "O", "DISPLAYBASE", "12210"
"CONVYR", "CATCON2", "LS(SOLD,3,CHGRD);TE('clr %4.1lf', 'VERCLR', 3,1,2, '15110', 1,0, CHBLK, 11)", "8", "O", "DISPLAYBASE", "12210"
"CONVYR", "CONRAD1", "LS(DASH,4,CHGRD);SY(RACNSP01);TE('clr %4.1lf', 'VERCLR', 3,1,2, '15110', 1,0, CHBLK, 11)", "8", "O", "DISPLAYBASE", "12210"
"CONVYR", "CONRAD3", "LS(DASH,4,CHGRD);SY(RACNSP01);TE('clr %4.1lf', 'VERCLR', 3,1,2, '15110', 1,0, CHBLK, 11)", "8", "O", "DISPLAYBASE", "12210"
"DAMCON", "", "LS(SOLD,4,LANDF)", "6", "O", "STANDARD", "22010"
"DAMCON", "CATDAM3", "LS(SOLD,2,CSTLN)", "6", "O", "DISPLAYBASE", "12410"

```

"DEPARE", "", "", "", "", ""  
 "DEPCNT", "", "", "CS(DEPCNT03)", "5", "O", "OTHER", "33020"  
 "DWRACL", "", "", "LC(DWLDEF01);TE(%03.0lf deg', 'ORIENT', 1, 1, 2, '15110', 0, -1, CHBLK, 11)", "6", "O", "STANDARD", "25010"  
 "DWRACL", "CATTRK1TRAFIC1", "LC(DWRACL08);TE(%03.0lf deg', 'ORIENT', 1, 1, 2, '15110', 0, -1, CHBLK, 11)", "6", "O", "STANDARD", "25010"  
 "DWRACL", "CATTRK1TRAFIC2", "LC(DWRACL08);TE(%03.0lf deg', 'ORIENT', 1, 1, 2, '15110', 0, -1, CHBLK, 11)", "6", "O", "STANDARD", "25010"  
 "DWRACL", "CATTRK1TRAFIC3", "LC(DWRACL08);TE(%03.0lf deg', 'ORIENT', 1, 1, 2, '15110', 0, -1, CHBLK, 11)", "6", "O", "STANDARD", "25010"  
 "DWRACL", "CATTRK1TRAFIC4", "LC(DWRACL06);TE(%03.0lf deg', 'ORIENT', 1, 1, 2, '15110', 0, -1, CHBLK, 11)", "6", "O", "STANDARD", "25010"  
 "DWRACL", "CATTRK2TRAFIC1", "LC(DWRACL07);TE(%03.0lf deg', 'ORIENT', 1, 1, 2, '15110', 0, -1, CHBLK, 11)", "6", "O", "STANDARD", "25010"  
 "DWRACL", "CATTRK2TRAFIC2", "LC(DWRACL07);TE(%03.0lf deg', 'ORIENT', 1, 1, 2, '15110', 0, -1, CHBLK, 11)", "6", "O", "STANDARD", "25010"  
 "DWRACL", "CATTRK2TRAFIC3", "LC(DWRACL07);TE(%03.0lf deg', 'ORIENT', 1, 1, 2, '15110', 0, -1, CHBLK, 11)", "6", "O", "STANDARD", "25010"  
 "DWRACL", "CATTRK2TRAFIC4", "LC(DWRACL05);TE(%03.0lf deg', 'ORIENT', 1, 1, 2, '15110', 0, -1, CHBLK, 11)", "6", "O", "STANDARD", "25010"  
 "DWRACL", "TRAFIC1", "LC(DWRACL07);TE(%03.0lf deg', 'ORIENT', 1, 1, 2, '15110', 0, -1, CHBLK, 11)", "6", "O", "STANDARD", "25010"  
 "DWRACL", "TRAFIC2", "LC(DWRACL07);TE(%03.0lf deg', 'ORIENT', 1, 1, 2, '15110', 0, -1, CHBLK, 11)", "6", "O", "STANDARD", "25010"  
 "DWRACL", "TRAFIC3", "LC(DWRACL07);TE(%03.0lf deg', 'ORIENT', 1, 1, 2, '15110', 0, -1, CHBLK, 11)", "6", "O", "STANDARD", "25010"  
 "DWRACL", "TRAFIC4", "LC(DWRACL05);TE(%03.0lf deg', 'ORIENT', 1, 1, 2, '15110', 0, -1, CHBLK, 11)", "6", "O", "STANDARD", "25010"  
 "DYKCON", "", "", "LS(SOLD, 3, LANDF)", "4", "O", "STANDARD", "22010"  
 "DYKCON", "CONRAD1", "LS(SOLD, 2, CHBLK)", "4", "O", "STANDARD", "22210"  
 "FERYRT", "", "LC(FERYRT02)", "4", "O", "STANDARD", "25030"  
 "FERYRT", "CATFRY1", "LC(FERYRT01)", "4", "O", "STANDARD", "25030"  
 "FERYRT", "CATFRY2", "LC(FERYRT02)", "4", "O", "STANDARD", "25030"  
 "FLODOC", "", "", "LS(SOLD, 3, CSTLN)", "5", "O", "DISPLAYBASE", "12410"  
 "FNCLNE", "", "LS(SOLD, 1, LANDF)", "3", "O", "OTHER", "32220"  
 "FNCLNE", "CONVIS1", "LS(SOLD, 1, CHBLK)", "3", "O", "STANDARD", "22220"  
 "FORSTC", "", "LS(SOLD, 3, LANDF)", "4", "O", "OTHER", "32220"  
 "FSHFAC", "", "LS(DASH, 2, CHGRD)", "4", "O", "OTHER", "34040"  
 "FSHFAC", "CATFIF1", "LC(FSHFAC02)", "4", "O", "OTHER", "34040"  
 "GATCON", "", "LS(SOLD, 2, CSTLN)", "8", "O", "DISPLAYBASE", "12410"  
 "GATCON", "CATGAT2", "LS(SOLD, 2, CSTLN)", "8", "O", "DISPLAYBASE", "12410"  
 "GATCON", "CATGAT3", "LS(SOLD, 2, CSTLN);SY(GATCON04)", "8", "O", "DISPLAYBASE", "12410"  
 "GATCON", "CATGAT4", "LS(SOLD, 2, CSTLN);SY(GATCON03)", "8", "O", "DISPLAYBASE", "12410"  
 "GATCON", "CATGAT5", "LS(SOLD, 2, CSTLN)", "8", "O", "DISPLAYBASE", "12410"  
 "LNDARE", "", "CS(QUAPOS01);TX(OBJNAM, 1, 1, 2, '15110', 0, 1, CHBLK, 26)", "8", "O", "DISPLAYBASE", "12010"  
 "LNDELV", "", "LS(SOLD, 1, LANDF)", "4", "O", "OTHER", "32010"  
 "LNDMRK", "", "LS(SOLD, 1, LANDF)", "4", "O", "OTHER", "32220"  
 "LNDMRK", "CONVIS1", "LS(SOLD, 1, CHBLK)", "4", "O", "STANDARD", "22220"  
 "LOCMAG", "", "LS(DASH, 1, CHMGF);SY(LOCMAG01)", "4", "S", "OTHER", "31080"  
 "M\_SREL", "", "", "", "", ""  
 "MAGVAR", "", "LS(SOLD, 2, CHMGF);SY(MAGVAR51);TE('varn %s', 'VALMAG', 3, 1, 2, '15110', 1, -1, CHBLK, 27)", "4", "O", "OTHER", "31080"  
 "MARCUL", "", "LS(DASH, 2, CHGRF)", "4", "O", "STANDARD", "26210"  
 "MORFAC", "", "LS(SOLD, 2, CSTLN)", "6", "O", "DISPLAYBASE", "12410"  
 "MORFAC", "CATMOR4", "LS(SOLD, 2, CSTLN)", "6", "O", "DISPLAYBASE", "12410"  
 "MORFAC", "CATMOR6", "LS(DASH, 1, CHMGF)", "6", "O", "DISPLAYBASE", "14010"  
 "NAVLNE", "", "LS(DASH, 1, CHGRD)", "4", "O", "STANDARD", "25010"  
 "NAVLNE", "CATNAV1", "LS(DASH, 1, CHGRD);TE(%03.0lf deg', 'ORIENT', 1, 1, 2, '15110', 0, -1, CHBLK, 11)", "4", "O", "STANDARD", "25010"  
 "NAVLNE", "CATNAV2", "LS(DASH, 1, CHGRD);TE(%03.0lf deg', 'ORIENT', 1, 1, 2, '15110', 0, -1, CHBLK, 11)", "4", "O", "STANDARD", "25010"  
 "NEWOBJ", "", "LC(NEWOBJ01)", "6", "S", "STANDARD", "21020"  
 "NEWOBJ", "SYMINS", "CS(SYMINS01)", "6", "S", "STANDARD", "21020"  
 "OBSTRN", "", "CS(OBSTRN06)", "4", "O", "OTHER", "34050"  
 "OBSTRN", "CATOBS8", "LS(DASH, 1, CSTLN)", "4", "O", "DISPLAYBASE", "12410"

"OBSTRN","CATOBS9","LS(DASH,1,CHMGD)","4","O","DISPLAYBASE","12410"  
"OBSTRN","CATOBS10","LS(DASH,1,CSTLN)","4","O","DISPLAYBASE","12410"  
"OBSTRN","WATLEV7","LS(DASH,1,CSTLN)","4","O","DISPLAYBASE","12410"  
"OILBAR","","LS(DASH,1,CHBLK)","4","O","DISPLAYBASE","12410"  
"PIPOHD","","LS(SOLD,3,CHGRD);TE('clr %4.1lf,VERCLR',3,1,2,'15110',1,-1,CHBLK,11))","8","O","DISPLAYBASE","12210"  
"PIPOHD","CONRAD1","LS(SOLD,3,CHGRD);SY(RACNSP01);TE('clr %4.1lf,VERCLR',3,1,2,'15110',1,-1,CHBLK,11))","8","O","DISPLAYBASE","12210"  
"PIPOHD","CONRAD3","LS(SOLD,3,CHGRD);SY(RACNSP01);TE('clr %4.1lf,VERCLR',3,1,2,'15110',1,-1,CHBLK,11))","8","O","DISPLAYBASE","12210"  
"PIPSOL","","LC(PIPSOL05)","6","O","OTHER","34070"  
"PIPSOL","PRODCT3","LC(PIPSOL06)","6","O","OTHER","34070"  
"PIPSOL","CATPIP2","LC(PIPSOL06)","6","O","OTHER","34070"  
"PIPSOL","CATPIP3","LC(PIPSOL06)","6","O","OTHER","34070"  
"PIPSOL","CATPIP4","LC(PIPSOL06)","6","O","OTHER","34070"  
"PIPSOL","CATPIP5","LC(PIPSOL06)","6","O","OTHER","34070"  
"PONTON","","LS(SOLD,2,CSTLN)","5","O","DISPLAYBASE","12410"  
"RADLNE","","LS(DASH,2,TRFCD);TE('%03.0lf deg',ORIENT',1,1,2,'15110',0,-1,CHBLK,11))","6","O","STANDARD","25040"  
"RAILWY","","LS(SOLD,2,LANDF)","4","O","OTHER","32250"  
"RAPIDS","","LS(SOLD,3,CHGRD)","3","O","OTHER","32050"  
"RCRTCL","","LC(RCRDEF11);TE('%03.0lf deg',ORIENT',1,1,2,'15110',0,-1,CHBLK,11))","6","O","STANDARD","25020"  
"RCRTCL","CATTRK1TRAFIC1","LC(RCRTCL14);TE('%03.0lf deg',ORIENT',1,1,2,'15110',0,-1,CHBLK,11))","6","O","STANDARD","25020"  
"RCRTCL","CATTRK1TRAFIC2","LC(RCRTCL14);TE('%03.0lf deg',ORIENT',1,1,2,'15110',0,-1,CHBLK,11))","6","O","STANDARD","25020"  
"RCRTCL","CATTRK1TRAFIC3","LC(RCRTCL14);TE('%03.0lf deg',ORIENT',1,1,2,'15110',0,-1,CHBLK,11))","6","O","STANDARD","25020"  
"RCRTCL","CATTRK1TRAFIC4","LC(RCRTCL13);TE('%03.0lf deg',ORIENT',1,1,2,'15110',0,-1,CHBLK,11))","6","O","STANDARD","25020"  
"RCRTCL","CATTRK2TRAFIC1","LC(RCRTCL12);TE('%03.0lf deg',ORIENT',1,1,2,'15110',0,-1,CHBLK,11))","6","O","STANDARD","25020"  
"RCRTCL","CATTRK2TRAFIC2","LC(RCRTCL12);TE('%03.0lf deg',ORIENT',1,1,2,'15110',0,-1,CHBLK,11))","6","O","STANDARD","25020"  
"RCRTCL","CATTRK2TRAFIC3","LC(RCRTCL12);TE('%03.0lf deg',ORIENT',1,1,2,'15110',0,-1,CHBLK,11))","6","O","STANDARD","25020"  
"RCRTCL","CATTRK2TRAFIC4","LC(RCRTCL11);TE('%03.0lf deg',ORIENT',1,1,2,'15110',0,-1,CHBLK,11))","6","O","STANDARD","25020"  
"RCRTCL","TRAFIC1","LC(RCRTCL12);TE('%03.0lf deg',ORIENT',1,1,2,'15110',0,-1,CHBLK,11))","6","O","STANDARD","25020"  
"RCRTCL","TRAFIC2","LC(RCRTCL12);TE('%03.0lf deg',ORIENT',1,1,2,'15110',0,-1,CHBLK,11))","6","O","STANDARD","25020"  
"RCRTCL","TRAFIC3","LC(RCRTCL12);TE('%03.0lf deg',ORIENT',1,1,2,'15110',0,-1,CHBLK,11))","6","O","STANDARD","25020"  
"RCRTCL","TRAFIC4","LC(RCRTCL11);TE('%03.0lf deg',ORIENT',1,1,2,'15110',0,-1,CHBLK,11))","6","O","STANDARD","25020"  
"RDOCAL","","LS(DASH,1,TRFCD);SY(RCLDEF01);TE('Nr %s',OBJNAM',3,1,2,'15110',1,-1,CHBLK,21))","6","O","STANDARD","25060"  
"RDOCAL","TRAFIC1ORIENT","LS(DASH,1,TRFCD);SY(RDOCAL02,ORIENT);TE('Nr %s',OBJNAM',3,1,2,'15110',1,-1,CHBLK,21);TE('ch %s',COMCHA',3,1,2,'15110',1,1,CHBLK,11))","6","O","STANDARD","25060"  
"RDOCAL","TRAFIC2ORIENT","LS(DASH,1,TRFCD);SY(RDOCAL02,ORIENT);TE('Nr %s',OBJNAM',3,1,2,'15110',1,-1,CHBLK,21);TE('ch %s',COMCHA',3,1,2,'15110',1,1,CHBLK,11))","6","O","STANDARD","25060"  
"RDOCAL","TRAFIC3ORIENT","LS(DASH,1,TRFCD);SY(RDOCAL02,ORIENT);TE('Nr %s',OBJNAM',3,1,2,'15110',1,-1,CHBLK,21);TE('ch %s',COMCHA',3,1,2,'15110',1,1,CHBLK,11))","6","O","STANDARD","25060"  
"RDOCAL","TRAFIC4ORIENT","LS(DASH,1,TRFCD);SY(RDOCAL03,ORIENT);TE('Nr %s',OBJNAM',3,1,2,'15110',1,-1,CHBLK,21);TE('ch %s',COMCHA',3,1,2,'15110',1,1,CHBLK,11))","6","O","STANDARD","25060"  
"RECTRC","","LC(RECDEF02);TE('%03.0lf deg',ORIENT',1,1,2,'15110',0,-1,CHBLK,11))","6","O","STANDARD","25020"  
"RECTRC","CATTRK1TRAFIC1","LC(RECTRC12);TE('%03.0lf deg',ORIENT',1,1,2,'15110',0,-1,CHBLK,11))","6","O","STANDARD","25020"  
"RECTRC","CATTRK1TRAFIC2","LC(RECTRC12);TE('%03.0lf deg',ORIENT',1,1,2,'15110',0,-1,CHBLK,11))","6","O","STANDARD","25020"  
"RECTRC","CATTRK1TRAFIC3","LC(RECTRC12);TE('%03.0lf deg',ORIENT',1,1,2,'15110',0,-1,CHBLK,11))","6","O","STANDARD","25020"  
"RECTRC","CATTRK1TRAFIC4","LC(RECTRC10);TE('%03.0lf deg',ORIENT',1,1,2,'15110',0,-1,CHBLK,11))","6","O","STANDARD","25020"  
"RECTRC","CATTRK2TRAFIC1","LC(RECTRC11);TE('%03.0lf deg',ORIENT',1,1,2,'15110',0,-1,CHBLK,11))","6","O","STANDARD","25020"  
"RECTRC","CATTRK2TRAFIC2","LC(RECTRC11);TE('%03.0lf deg',ORIENT',1,1,2,'15110',0,-1,CHBLK,11))","6","O","STANDARD","25020"  
"RECTRC","CATTRK2TRAFIC3","LC(RECTRC11);TE('%03.0lf deg',ORIENT',1,1,2,'15110',0,-1,CHBLK,11))","6","O","STANDARD","25020"  
"RECTRC","CATTRK2TRAFIC4","LC(RECTRC09);TE('%03.0lf deg',ORIENT',1,1,2,'15110',0,-1,CHBLK,11))","6","O","STANDARD","25020"  
"RECTRC","TRAFIC1","LC(RECTRC11);TE('%03.0lf deg',ORIENT',1,1,2,'15110',0,-1,CHBLK,11))","6","O","STANDARD","25020"

```

"RECTRC", "TRAFIC2", "LC(RECTRC11);TE(%03.0lf deg', 'ORIENT', 1, 1, 2, '15110', 0, -1, CHBLK, 11)", "6", "O", "STANDARD", "25020"
"RECTRC", "TRAFIC3", "LC(RECTRC11);TE(%03.0lf deg', 'ORIENT', 1, 1, 2, '15110', 0, -1, CHBLK, 11)", "6", "O", "STANDARD", "25020"
"RECTRC", "TRAFIC4", "LC(RECTRC09);TE(%03.0lf deg', 'ORIENT', 1, 1, 2, '15110', 0, -1, CHBLK, 11)", "6", "O", "STANDARD", "25020"
"RIVERS", "LS(SOLD, 1, CHBLK)", "2", "O", "DISPLAYBASE", "12420"
"ROADWY", "LS(SOLD, 2, LANDF)", "4", "O", "OTHER", "32250"
"RUNWAY", "LS(SOLD, 3, LANDF)", "6", "O", "OTHER", "32240"
"SBDARE", "LS(SOLD, 1, CHGRD);TX(NATSUR, 1, 2, 2, '15110', 0, 0, CHBLK, 25)", "4", "O", "OTHER", "34010"
"SLCONS", "CS(SLCONS03)", "7", "O", "DISPLAYBASE", "12410"
"SLOTOP", "LS(SOLD, 1, LANDF)", "4", "O", "OTHER", "32010"
"SLOTOP", "CATSLO2CONRAD1", "LS(SOLD, 1, CHBLK)", "4", "O", "STANDARD", "22210"
"SLOTOP", "CATSLO6CONRAD1", "LS(SOLD, 1, CHBLK)", "4", "O", "STANDARD", "22210"
"SLOTOP", "CATSLO6CONVIS1", "LS(SOLD, 1, CHBLK)", "4", "O", "STANDARD", "22210"
"SLOTOP", "CATSLO2", "LS(SOLD, 1, CHGRD)", "4", "O", "OTHER", "32010"
"SLOTOP", "CATSLO6", "LS(SOLD, 1, CHGRD)", "4", "O", "OTHER", "32010"
"SNDWAV", "LS(DASH, 2, CHGRD);SY(SNDWAV02)", "4", "O", "STANDARD", "24010"
"STSLNE", "LS(DASH, 1, CHGRF)", "3", "O", "OTHER", "36050"
"TIDEWY", "LS(SOLD, 1, CHGRF)", "3", "O", "OTHER", "32070"
"TSelNE", "LS(SOLD, 6, TRFCF)", "8", "O", "STANDARD", "25010"
"TSSBND", "LS(DASH, 4, TRFCD)", "7", "O", "STANDARD", "25010"
"TUNNEL", "LS(DASH, 1, CHGRD)", "4", "O", "OTHER", "32250"
"TUNNEL", "BURDEPO", "LS(DASH, 2, CHBLK)", "4", "O", "STANDARD", "24010"
"VEGATN", "LS(DASH, 1, LANDF)", "3", "O", "OTHER", "32030"
"WATFAL", "LS(SOLD, 3, CHGRF)", "3", "O", "OTHER", "32050"
"WATFAL", "CONVIS1", "LS(SOLD, 3, CHWHT)", "3", "O", "OTHER", "32050"
"WATTUR", "LS(DASH, 1, CHGRD);SY(WATTUR02)", "4", "O", "OTHER", "33040"

```

\*

\* \*\* \*

\* \*\* \* section two: NON-STANDARD CLASSES \*\* \*

\* \*\* \*

\*

\*Note: category "DISPLAYBASE" should not be removed from the display.

\*For non-standard classes, all category "MARINERS STANDARD" and "MARINERS OTHER"

\*should be drawn when "STANDARD DISPLAY" is drawn, and thereafter may be re-assigned

\*to the category of chosen by the mariner.

\*

```

"clrlin", "CS(CLRLIN01)", "9", "O", "MARINERS OTHER", "53020"
"dnghlt", "LS(SOLD, 3, DNGHL)", "8", "O", "MARINERS STANDARD", "53010"
"ebline", "CS(VRMEBL01)", "9", "O", "MARINERS OTHER", "61010"
"leglin", "CS(LEGLIN03)", "8", "O", "DISPLAYBASE", "42210"
"marfea", "LS(SOLD, 2, NINFO);TX(OBJNAM, 3, 3, 2, '15110', 0, 1, CHBLK, 50)", "8", "O", "MARINERS OTHER", "53050"
"mnufea", "LS(SOLD, 1, ADINF)", "5", "O", "MARINERS OTHER", "55010"
"pastrk", "CS(PASTRK01)", "3", "O", "MARINERS STANDARD", "52430"
"poslin", "LS(SOLD, 1, NINFO);TX(loctim, 3, 1, 2, '15110', 0, -1, CHBLK, 50)", "3", "O", "MARINERS OTHER", "62020"
"poslin", "transf2", "LS(SOLD, 1, NINFO);TX(loctim, 3, 1, 2, '15110', 0, -1, CHBLK, 50);TX(TPL, 3, 3, 2, '15110', 0, 1, CHBLK, 50)", "3", "O", "MARINERS OTHER", "62020"
"rngrng", "LS(SOLD, 1, CURSR)", "9", "O", "MARINERS OTHER", "61030"
"vrmark", "CS(VRMEBL01)", "9", "O", "MARINERS OTHER", "61010"

```

```
"wholin", "", "LS(SOLD,2,NINFO);TX(loctim,3,3,2,'15110',0,1,CHBLK,50);TX(usrmrk,3,1,2,'15110',0,-1,CHBLK,50)", "8", "O", "MARINERS STANDARD", "52010"
*
* ***                ***
* *** end of look-up table ***
* ***                ***
```

## 11.3 Look-up Table Listing for Object Type Area 'A'

### 11.3.1 Look-up Table for areas with symbolized boundaries

```
* *** AREAS WITH SYMBOLIZED BOUNDARIES                ***
* *** This is the look-up table for area symbolization. ***
* *** For edition 3.4 Preslib, dated January 2008      *****
*
* Each line contains minimum 6 fields:
* 1. field - code of the object class
* 2. field - attribute combination
* 3. field - symbolization instruction
* 4. field - display priority
* 5. field - radar
* 6. field - IMO display category
* 7. field - viewing group (optional)
*
* Each field entry is framed by "" and fields are separated by ','.
*
* Please note, that the entries to this table must be in
* alphabetic order (sorted by the class code).
*
* This table has 2 sections:
*
* - The first section contains symbolization instructions for
* standard S-57 'real world' objects:
* - The second section contains symbolization instructions for
* non-standard (class code in lowercase) objects:
*
* default for symbolization failure; must be the first entry to look-up table
"#####", "", "SY(QUESMRK1);LC(QUESMRK1)", "5", "S", "STANDARD", "21010"
*
```



```

* ***          ***
* *** section one: REAL WORLD CLASSES ***
* ***          ***
*
"ACHARE", "", "SY(ACHARE51);LC(ACHARE51);CS(RESTRN01)", "3", "S", "STANDARD", "26220"
"ACHARE", "CATACH8", "SY(ACHARE02);LS(DASH,2,CHMGF);CS(RESTRN01)", "3", "S", "STANDARD", "26220"
"ACHBRT", "", "SY(ACHBRT07);TE('Nr %s',OBJNAM,3,1,2,'15110',1,0,CHBLK,29);LS(DASH,2,CHMGF)", "5", "S", "STANDARD", "26220"
"ADMARE", "", "LC(ADMARE01)", "2", "S", "OTHER", "36050"
"AIRARE", "", "AP(AIRARE02);LS(SOLD,1,LANDF)", "2", "S", "OTHER", "32240"
"AIRARE", "CONVIS1", "AC(LANDA);AP(AIRARE02);LS(SOLD,1,CHBLK)", "2", "S", "STANDARD", "22220"
"ARCSLN", "", "LC(ARCSLN01)", "5", "S", "STANDARD", "26260"
"BERTHS", "", "SY(BRTHNO01);TE('Nr %s',OBJNAM,3,1,2,'15110',1,0,CHBLK,29)", "3", "S", "OTHER", "32440"
"BRIDGE", "", "TX(OBJNAM,3,1,2,'15110',1,0,CHBLK,21);TE('clr %4.1lf',VERCLR,3,1,2,'15110',1,1,CHBLK,11);LS(SOLD,4,CHGRD)", "8", "O", "DISPLAYBASE", "12210"
"BRIDGE", "CATBRG2", "SY(BRIDGE01);TE('clr cl %4.1lf',VERCCL,3,1,2,'15110',1,0,CHBLK,11);TE('clr op %4.1lf',VERCOP,3,1,2,'15110',1,1,CHBLK,11);LS(SOLD,4,CHGRD)", "8", "O", "DISPLAYBASE", "12210"
"BRIDGE", "CATBRG3", "SY(BRIDGE01);TE('clr cl %4.1lf',VERCCL,3,1,2,'15110',1,0,CHBLK,11);TE('clr op %4.1lf',VERCOP,3,1,2,'15110',1,1,CHBLK,11);LS(SOLD,4,CHGRD)", "8", "O", "DISPLAYBASE", "12210"
"BRIDGE", "CATBRG4", "SY(BRIDGE01);TE('clr cl %4.1lf',VERCCL,3,1,2,'15110',1,0,CHBLK,11);TE('clr op %4.1lf',VERCOP,3,1,2,'15110',1,1,CHBLK,11);LS(SOLD,4,CHGRD)", "8", "O", "DISPLAYBASE", "12210"
"BRIDGE", "CATBRG5", "SY(BRIDGE01);TE('clr cl %4.1lf',VERCCL,3,1,2,'15110',1,0,CHBLK,11);TE('clr op %4.1lf',VERCOP,3,1,2,'15110',1,1,CHBLK,11);LS(SOLD,4,CHGRD)", "8", "O", "DISPLAYBASE", "12210"
"BRIDGE", "CATBRG7", "SY(BRIDGE01);TE('clr cl %4.1lf',VERCCL,3,1,2,'15110',1,0,CHBLK,11);TE('clr op %4.1lf',VERCOP,3,1,2,'15110',1,1,CHBLK,11);LS(SOLD,4,CHGRD)", "8", "O", "DISPLAYBASE", "12210"
"BRIDGE", "CATBRG8", "SY(BRIDGE01);TE('clr cl %4.1lf',VERCCL,3,1,2,'15110',1,0,CHBLK,11);TE('clr op %4.1lf',VERCOP,3,1,2,'15110',1,1,CHBLK,11);LS(SOLD,4,CHGRD)", "8", "O", "DISPLAYBASE", "12210"
"BUAARE", "", "AC(CHBRN);TX(OBJNAM,1,2,3,'15110',0,0,CHBLK,26);LS(SOLD,1,LANDF)", "3", "S", "STANDARD", "22240"
"BUISGL", "", "AC(CHBRN);LS(SOLD,1,LANDF)", "4", "S", "OTHER", "32220"
"BUISGL", "FUNCTN33CONVIS1", "AC(CHBRN);TX(OBJNAM,1,2,2,'15110',0,0,CHBLK,26);LS(SOLD,1,CHBLK)", "4", "S", "STANDARD", "22220"
"BUISGL", "FUNCTN33", "AC(CHBRN);TX(OBJNAM,1,2,2,'15110',0,0,CHBLK,26);LS(SOLD,1,LANDF)", "4", "S", "OTHER", "32220"
"BUISGL", "CONVIS1", "AC(CHBRN);LS(SOLD,1,CHBLK)", "4", "S", "STANDARD", "22220"
"CANALS", "", "AC(DEPVS);LS(SOLD,1,CHBLK)", "2", "S", "DISPLAYBASE", "12420"
"CANALS", "CONDNTN", "AC(DEPVS);LS(DASH,1,CHBLK)", "2", "S", "DISPLAYBASE", "12420"
"CAUSWY", "", "AC(CHBRN);LS(SOLD,1,CSTLN)", "5", "S", "STANDARD", "22010"
"CAUSWY", "WATLEV4", "AC(DEPIT);LS(DASH,2,CSTLN)", "5", "S", "STANDARD", "22010"
"CBLARE", "", "SY(CBLARE51);LC(CBLARE51);CS(RESTRN01)", "3", "S", "STANDARD", "26230"
"CHKPNT", "", "SY(POSGEN04)", "4", "S", "OTHER", "32410"
"CONVYR", "", "TE('clr %4.1lf',VERCLR,3,1,2,'15110',1,0,CHBLK,11);LS(SOLD,3,CHGRD)", "8", "O", "DISPLAYBASE", "12210"
"CONVYR", "CONRAD1", "SY(RACNSP01);TE('clr %4.1lf',VERCLR,3,1,2,'15110',1,0,CHBLK,11);LS(SOLD,3,CHGRD)", "8", "O", "DISPLAYBASE", "12210"
"CONVYR", "CONRAD3", "SY(RACNSP01);TE('clr %4.1lf',VERCLR,3,1,2,'15110',1,0,CHBLK,11);LS(SOLD,3,CHGRD)", "8", "O", "DISPLAYBASE", "12210"
"CONZNE", "", "LS(DASH,2,CHGRF)", "2", "S", "OTHER", "36050"
"COSARE", "", "LS(DASH,2,CHGRF)", "2", "S", "OTHER", "36010"
"CRANES", "", "AC(CHBRN);LS(SOLD,1,LANDF)", "4", "S", "OTHER", "32440"
"CRANES", "CONVIS1", "AC(CHBRN);LS(SOLD,1,CHBLK)", "4", "S", "STANDARD", "22220"
"CTNARE", "", "SY(CTNARE51);LC(CTNARE51)", "3", "S", "STANDARD", "26050"
"CTSARE", "", "SY(INFARE51);LC(CTYARE51)", "3", "S", "STANDARD", "26250"
"CUSZNE", "", "LS(DASH,1,CHGRF)", "2", "S", "OTHER", "36020"
"DAMCON", "", "AC(CHBRN);LS(SOLD,1,LANDF)", "3", "S", "STANDARD", "22010"
"DAMCON", "CATDAM3", "AC(CHBRN);LS(SOLD,2,CSTLN)", "6", "S", "DISPLAYBASE", "12410"

```

"DEPARE", "", "CS(DEPARE02)", "1", "S", "DISPLAYBASE", "13030"  
 "DEPARE", "DRVAL1?DRVAL2?", "AC(NODTA);AP(PRTSUR01);LS(SOLD,2,CHGRD)", "1", "S", "DISPLAYBASE", "13030"  
 "DMPGRD", "", "SY(INFARE51);LC(CTYARE51);CS(RESTRN01)", "3", "S", "STANDARD", "26240"  
 "DOCARE", "", "AC(DEPVS);TX(OBJNAM,1,2,3,'15110',0,0,CHBLK,26);LS(SOLD,1,CHBLK)", "2", "S", "DISPLAYBASE", "12420"  
 "DOCARE", "CONDTN", "AC(DEPVS);TX(OBJNAM,1,2,3,'15110',0,0,CHBLK,26);LS(DASH,1,CHBLK)", "2", "S", "DISPLAYBASE", "12420"  
 "DRGARE", "", "CS(DEPARE02)", "1", "S", "DISPLAYBASE", "13030"  
 "DRYDOC", "", "AC(LANDA);LS(SOLD,1,CSTLN)", "4", "S", "OTHER", "32440"  
 "DWRTPPT", "", "SY(TSLDEF51);SY(DWRTPPT51);LC(DWRUTE51);CS(RESTRN01)", "4", "S", "STANDARD", "25010"  
 "DWRTPPT", "ORIENTTRAFIC1", "SY(TSSLPT51,ORIENT);SY(DWRTPPT51);LC(DWRUTE51);CS(RESTRN01)", "4", "S", "STANDARD", "25010"  
 "DWRTPPT", "ORIENTTRAFIC2", "SY(TSSLPT51,ORIENT);SY(DWRTPPT51);LC(DWRUTE51);CS(RESTRN01)", "4", "S", "STANDARD", "25010"  
 "DWRTPPT", "ORIENTTRAFIC3", "SY(TSSLPT51,ORIENT);SY(DWRTPPT51);LC(DWRUTE51);CS(RESTRN01)", "4", "S", "STANDARD", "25010"  
 "DWRTPPT", "ORIENTTRAFIC4", "SY(DWRUTE51,ORIENT);SY(DWRTPPT51);LC(DWRUTE51);CS(RESTRN01)", "4", "S", "STANDARD", "25010"  
 "DYKCON", "", "AC(CHBRN);LS(SOLD,1,LANDF)", "3", "S", "STANDARD", "22010"  
 "EXEZNE", "", "LS(DASH,2,CHGRF)", "2", "S", "OTHER", "36050"  
 "FAIRWY", "", "LC(NAVARE51);CS(RESTRN01)", "4", "S", "STANDARD", "26050"  
 "FAIRWY", "ORIENTTRAFIC1", "SY(FAIRWY51,ORIENT);LC(NAVARE51);CS(RESTRN01)", "4", "S", "STANDARD", "26050"  
 "FAIRWY", "ORIENTTRAFIC2", "SY(FAIRWY51,ORIENT);LC(NAVARE51);CS(RESTRN01)", "4", "S", "STANDARD", "26050"  
 "FAIRWY", "ORIENTTRAFIC3", "SY(FAIRWY51,ORIENT);LC(NAVARE51);CS(RESTRN01)", "4", "S", "STANDARD", "26050"  
 "FAIRWY", "ORIENTTRAFIC4", "SY(FAIRWY52,ORIENT);LC(NAVARE51);CS(RESTRN01)", "4", "S", "STANDARD", "26050"  
 "FERYRT", "", "SY(FRYARE51);LC(NAVARE51)", "3", "S", "STANDARD", "26040"  
 "FERYRT", "CATFRY2", "SY(FRYARE52);LC(NAVARE51)", "3", "S", "STANDARD", "26040"  
 "FLODOC", "", "AC(CHBRN);LS(SOLD,2,CSTLN)", "5", "S", "DISPLAYBASE", "12410"  
 "FORSTC", "", "AC(CHBRN);LS(SOLD,1,LANDF)", "4", "S", "OTHER", "32220"  
 "FORSTC", "CONVIS1", "AC(CHBRN);LS(SOLD,1,CHBLK)", "4", "S", "STANDARD", "22220"  
 "FRPARE", "", "LS(DASH,2,CHGRF)", "2", "S", "OTHER", "36020"  
 "FSHFAC", "", "SY(FSHFAC02);LC(NAVARE51)", "4", "S", "OTHER", "34040"  
 "FSHFAC", "CATFIF1", "SY(FSHFAC03);LC(NAVARE51)", "4", "S", "OTHER", "34040"  
 "FSHFAC", "CATFIF2", "SY(FSHFAC02);LC(NAVARE51)", "4", "S", "OTHER", "34040"  
 "FSHFAC", "CATFIF3", "SY(FSHFAC02);LC(NAVARE51)", "4", "S", "OTHER", "34040"  
 "FSHFAC", "CATFIF4", "SY(FSHFAC02);LC(NAVARE51)", "4", "S", "OTHER", "34040"  
 "FSHGRD", "", "SY(FSHGRD01);LS(DASH,2,CHGRF)", "3", "S", "STANDARD", "26210"  
 "FSHZNE", "", "LS(DASH,2,CHGRF)", "2", "S", "OTHER", "36040"  
 "GATCON", "", "AC(CHBRN);LS(SOLD,2,CSTLN)", "8", "S", "DISPLAYBASE", "12410"  
 "GRIDRN", "", "LS(DASH,1,CHGRD)", "5", "S", "OTHER", "32460"  
 "HRBARE", "", "LC(NAVARE51)", "2", "S", "OTHER", "36020"  
 "HRBFAC", "", "SY(CHINFO07)", "4", "S", "OTHER", "32410"  
 "HRBFAC", "CATHAF1", "SY(ROLROL01)", "4", "S", "OTHER", "32410"  
 "HRBFAC", "CATHAF4", "SY(HRBFAC09)", "4", "S", "OTHER", "32410"  
 "HRBFAC", "CATHAF5", "SY(SMCFAC02)", "4", "S", "OTHER", "32410"  
 "HULKES", "", "AC(CHBRN);LS(SOLD,2,CSTLN)", "5", "S", "DISPLAYBASE", "12410"  
 "ICEARE", "", "AC(NODTA);AP(ICEARE04);LS(DASH,1,CHGRD)", "3", "S", "DISPLAYBASE", "12410"  
 "ICNARE", "", "SY(INFARE51);LC(CTYARE51);CS(RESTRN01)", "3", "S", "STANDARD", "26250"  
 "ISTZNE", "", "SY(ITZARE51);LC(RESARE51);CS(RESTRN01)", "5", "S", "STANDARD", "25010"  
 "LAKARE", "", "AC(DEPVS);LS(SOLD,1,CHBLK)", "2", "S", "STANDARD", "22010"  
 "LNDARE", "", "AC(LANDA);TX(OBJNAM,1,2,3,'15110',-1,-1,CHBLK,26)", "1", "S", "DISPLAYBASE", "12010"  
 "LNDMRK", "", "AC(CHBRN);LS(SOLD,1,LANDF)", "4", "S", "OTHER", "32220"  
 "LNDMRK", "CATLMK17FUNCTN33CONVIS1", "AC(CHBRN);TX(OBJNAM,1,2,2,'15110',0,0,CHBLK,26);LS(SOLD,1,CHBLK)", "4", "S", "STANDARD", "22220"  
 "LNDMRK", "CATLMK17FUNCTN33", "AC(CHBRN);TX(OBJNAM,1,2,2,'15110',0,0,CHBLK,26);LS(SOLD,1,LANDF)", "4", "S", "OTHER", "32220"  
 "LNDMRK", "CONVIS1", "AC(CHBRN);LS(SOLD,1,CHBLK)", "4", "S", "STANDARD", "22220"



"PRDARE", "CATPRA8CONVIS1", "SY(TNKFRM11);LS(DASH,1,CHBLK)", "4", "S", "STANDARD", "22220"  
 "PRDARE", "CATPRA9CONVIS1", "SY(WNDFRM61);LS(DASH,1,CHBLK)", "4", "S", "STANDARD", "22220"  
 "PRDARE", "CATPRA1", "SY(QUARRY01);LS(DASH,1,LANDF)", "4", "S", "OTHER", "32270"  
 "PRDARE", "CATPRA5", "SY(RFNERY01);LS(DASH,1,LANDF)", "4", "S", "OTHER", "32270"  
 "PRDARE", "CATPRA6", "SY(TMBYRD01);LS(DASH,1,LANDF)", "4", "S", "OTHER", "32270"  
 "PRDARE", "CATPRA8", "SY(TNKFRM01);LS(DASH,1,LANDF)", "4", "S", "OTHER", "32270"  
 "PRDARE", "CATPRA9", "SY(WNDFRM51);LS(DASH,1,LANDF)", "4", "S", "OTHER", "32270"  
 "PYLONS", "AC(CHBRN);LS(SOLD,2,CSTLN)", "6", "S", "DISPLAYBASE", "12210"  
 "RADRNG", "LS(DASH,1,TRFCF)", "3", "S", "STANDARD", "25040"  
 "RAPIDS", "AC(CHGRD)", "3", "S", "OTHER", "32050"  
 "RCTLPT", "SY(RTLDEF51)", "4", "S", "STANDARD", "25020"  
 "RCTLPT", "ORIENT", "SY(RCTLPT52,ORIENT)", "4", "S", "STANDARD", "25020"  
 "RECTRC", "SY(RECDEF51);LC(NAVARE51)", "6", "S", "STANDARD", "25020"  
 "RECTRC", "ORIENTCATTRK1TRAFIC1", "SY(RECTRC58,ORIENT);TE(%03.0lf deg',ORIENT',3,2,2,'15110',4,0,CHBLK,11);LC(NAVARE51)", "6", "S", "STANDARD", "25020"  
 "RECTRC", "ORIENTCATTRK1TRAFIC2", "SY(RECTRC58,ORIENT);TE(%03.0lf deg',ORIENT',3,2,2,'15110',4,0,CHBLK,11);LC(NAVARE51)", "6", "S", "STANDARD", "25020"  
 "RECTRC", "ORIENTCATTRK1TRAFIC3", "SY(RECTRC58,ORIENT);TE(%03.0lf deg',ORIENT',3,2,2,'15110',4,0,CHBLK,11);LC(NAVARE51)", "6", "S", "STANDARD", "25020"  
 "RECTRC", "ORIENTCATTRK1TRAFIC4", "SY(RECTRC56,ORIENT);TE(%03.0lf deg',ORIENT',3,2,2,'15110',4,0,CHBLK,11);LC(NAVARE51)", "6", "S", "STANDARD", "25020"  
 "RECTRC", "ORIENTCATTRK2TRAFIC1", "SY(RECTRC57,ORIENT);TE(%03.0lf deg',ORIENT',3,2,2,'15110',4,0,CHBLK,11);LC(NAVARE51)", "6", "S", "STANDARD", "25020"  
 "RECTRC", "ORIENTCATTRK2TRAFIC2", "SY(RECTRC57,ORIENT);TE(%03.0lf deg',ORIENT',3,2,2,'15110',4,0,CHBLK,11);LC(NAVARE51)", "6", "S", "STANDARD", "25020"  
 "RECTRC", "ORIENTCATTRK2TRAFIC3", "SY(RECTRC57,ORIENT);TE(%03.0lf deg',ORIENT',3,2,2,'15110',4,0,CHBLK,11);LC(NAVARE51)", "6", "S", "STANDARD", "25020"  
 "RECTRC", "ORIENTCATTRK2TRAFIC4", "SY(RECTRC55,ORIENT);TE(%03.0lf deg',ORIENT',3,2,2,'15110',4,0,CHBLK,11);LC(NAVARE51)", "6", "S", "STANDARD", "25020"  
 "RECTRC", "ORIENTTRAFIC1", "SY(RECTRC57,ORIENT);TE(%03.0lf deg',ORIENT',3,2,2,'15110',4,0,CHBLK,11);LC(NAVARE51)", "6", "S", "STANDARD", "25020"  
 "RECTRC", "ORIENTTRAFIC2", "SY(RECTRC57,ORIENT);TE(%03.0lf deg',ORIENT',3,2,2,'15110',4,0,CHBLK,11);LC(NAVARE51)", "6", "S", "STANDARD", "25020"  
 "RECTRC", "ORIENTTRAFIC3", "SY(RECTRC57,ORIENT);TE(%03.0lf deg',ORIENT',3,2,2,'15110',4,0,CHBLK,11);LC(NAVARE51)", "6", "S", "STANDARD", "25020"  
 "RECTRC", "ORIENTTRAFIC4", "SY(RECTRC55,ORIENT);TE(%03.0lf deg',ORIENT',3,2,2,'15110',4,0,CHBLK,11);LC(NAVARE51)", "6", "S", "STANDARD", "25020"  
 "RESARE", "CS(RESARE03)", "5", "S", "STANDARD", "26010"  
 "RESARE", "CATREA27", "SY(ESSARE01);LC(ESSARE01)", "5", "S", "STANDARD", "26010"  
 "RESARE", "CATREA28", "SY(PSSARE01);LC(ESSARE01)", "5", "S", "STANDARD", "26010"  
 "RIVERS", "AC(DEPVS);LS(SOLD,1,CHBLK)", "2", "S", "DISPLAYBASE", "12420"  
 "ROADWY", "AC(LANDA);LS(SOLD,1,LANDF)", "4", "S", "OTHER", "32250"  
 "RUNWAY", "AC(CHBRN)", "5", "S", "OTHER", "32240"  
 "RUNWAY", "CONVIS1", "AC(CHBRN);LS(SOLD,1,CHBLK)", "5", "S", "STANDARD", "22220"  
 "SBDARE", "TX(NATSUR,1,2,2,'15110',0,0,CHBLK,25)", "3", "O", "OTHER", "34010"  
 "SBDARE", "WATLEV3NATSUR", "TX(NATSUR,1,2,2,'15110',0,0,CHBLK,25);LS(DASH,1,CHGRD)", "3", "S", "OTHER", "34010"  
 "SBDARE", "WATLEV4NATSUR9", "AP(RCKLDG01);LS(DASH,1,CHGRD)", "3", "S", "OTHER", "34010"  
 "SBDARE", "WATLEV4NATSUR11", "AP(RCKLDG01);LS(DASH,1,CHGRD)", "3", "S", "OTHER", "34010"  
 "SBDARE", "WATLEV4NATSUR14", "AP(RCKLDG01);LS(DASH,1,CHGRD)", "3", "S", "OTHER", "34010"  
 "SBDARE", "WATLEV4NATSUR", "TX(NATSUR,1,2,2,'15110',0,0,CHBLK,25);LS(DASH,1,CHGRD)", "3", "S", "OTHER", "34010"  
 "SEAARE", "TX(OBJNAM,1,2,3,'15110',0,0,CHBLK,26)", "3", "S", "STANDARD", "21060"  
 "SILTNK", "AC(CHBRN);LS(SOLD,1,LANDF)", "4", "S", "OTHER", "32220"  
 "SILTNK", "CONVIS1", "AC(CHBRN);LS(SOLD,1,CHBLK)", "4", "S", "STANDARD", "22220"  
 "SLCONS", "CS(SLCONS03)", "7", "S", "DISPLAYBASE", "12410"  
 "SLOGRD", "CATSLO1CONRAD1", "AC(CHGRD);LS(SOLD,1,CHBLK)", "3", "S", "OTHER", "32010"  
 "SLOGRD", "CATSLO2CONRAD1", "AC(CHGRD);LS(SOLD,1,CHBLK)", "3", "S", "OTHER", "32010"  
 "SLOGRD", "CATSLO3CONRAD1", "AC(CHGRD);LS(SOLD,1,CHBLK)", "3", "S", "OTHER", "32010"  
 "SLOGRD", "CATSLO4CONRAD1", "AC(CHGRD);LS(SOLD,1,CHBLK)", "3", "S", "OTHER", "32010"  
 "SLOGRD", "CATSLO5CONRAD1", "AC(CHGRD);LS(SOLD,1,CHBLK)", "3", "S", "OTHER", "32010"

"SLOGRD","CATSLO6","AC(CHGRD);LS(SOLD,1,CHBLK)","3","S","OTHER","32010"  
**"SLOGRD","CATSLO7CONRAD1","AC(CHGRD);LS(SOLD,1,CHBLK)","3","S","OTHER","32010"**  
 "SMCFAC","AC(CHBRN);SY(SMCFAC02);LS(SOLD,1,LANDF)","4","S","OTHER","38210"  
 "SNDWAV","AP(SNDWAV01);LC(NAVARE51)","4","S","STANDARD","24010"  
 "SPLARE","SY(CTYARE51);LC(CTYARE51);CS(RESTRN01)","4","S","STANDARD","26040"  
 "SUBTLN","SY(CTYARE51);LC(CTYARE51);CS(RESTRN01)","4","S","STANDARD","26040"  
 "SWPARE","SY(SWPARE51);TE('swept to %5.1lf','DRVAL1',1,2,2,'15110',0,1,CHBLK,27);LC(NAVARE51)","4","S","STANDARD","23030"  
 "T\_HMON","SY(TIDEHT01);LC(TIDINF51)","2","S","OTHER","33050"  
 "T\_NHMN","SY(TIDEHT01);LC(TIDINF51)","2","S","OTHER","33050"  
 "T\_TIMS","SY(TIDEHT01);LC(TIDINF51)","2","S","OTHER","33050"  
 "TS\_FEB","SY(CURDEF01);LC(TIDINF51)","2","S","OTHER","33060"  
 "TS\_FEB","CAT\_TS1ORIENT","SY(FLDSTR01,ORIENT);TE('%4.1lf kn','CURVEL',3,1,2,'15110',1,-1,CHBLK,31)","4","S","OTHER","33060"  
 "TS\_FEB","CAT\_TS2ORIENT","SY(EBBSTR01,ORIENT);TE('%4.1lf kn','CURVEL',3,1,2,'15110',1,-1,CHBLK,31)","4","S","OTHER","33060"  
 "TS\_FEB","CAT\_TS3ORIENT","SY(CURRENT01,ORIENT);TE('%4.1lf kn','CURVEL',3,1,2,'15110',1,-1,CHBLK,31)","4","S","OTHER","33060"  
 "TS\_PAD","SY(TIDSTR01);LC(TIDINF51)","2","S","OTHER","33060"  
 "TS\_PNH","SY(TIDSTR01);LC(TIDINF51)","2","S","OTHER","33060"  
 "TS\_PRH","SY(TIDSTR01);LC(TIDINF51)","2","S","OTHER","33060"  
 "TS\_TIS","SY(TIDSTR01);LC(TIDINF51)","2","S","OTHER","33060"  
 "TESARE","LS(DASH,2,CHGRF);CS(RESTRN01)","2","S","OTHER","36050"  
 "TIDEWY","LS(DASH,1,CHGRF);TX(OBJNAM,1,2,3,'15110',0,0,CHBLK,25)","7","S","OTHER","32070"  
 "TSEZNE","AC(TRFCF,3)","4","S","STANDARD","25010"  
 "TSSCRS","AP(TSSJCT02);SY(TSSCRS51);CS(RESTRN01)","6","S","STANDARD","25010"  
 "TSSLPT","AP(TSSJCT02);SY(CTNARE51);TX(INFORM,1,1,2,'15110',0,-2,CHBLK,24);CS(RESTRN01)","6","S","STANDARD","25010"  
 "TSSLPT","ORIENT","SY(TSSLPT51,ORIENT);CS(RESTRN01)","6","S","STANDARD","25010"  
 "TSSRON","AP(TSSJCT02);SY(TSSRON51);CS(RESTRN01)","6","S","STANDARD","25010"  
 "TUNNEL","LS(DASH,1,CHGRD)","4","S","OTHER","32250"  
 "TUNNEL","BURDEPO","AC(DEPVS);LS(DASH,1,CHBLK)","4","S","STANDARD","24010"  
 "TWRTPPT","SY(TWRDEF51);LC(CTYARE51)","4","S","STANDARD","25010"  
 "TWRTPPT","ORIENTTRAFIC1","SY(TWRTPPT53,ORIENT);LC(CTYARE51)","4","S","STANDARD","25010"  
 "TWRTPPT","ORIENTTRAFIC2","SY(TWRTPPT53,ORIENT);LC(CTYARE51)","4","S","STANDARD","25010"  
 "TWRTPPT","ORIENTTRAFIC3","SY(TWRTPPT53,ORIENT);LC(CTYARE51)","4","S","STANDARD","25010"  
 "TWRTPPT","ORIENTTRAFIC4","SY(TWRTPPT52,ORIENT);LC(CTYARE51)","4","S","STANDARD","25010"  
 "UNSAARE","AC(NODTA);AP(NODATA03);LS(SOLD,2,CHGRD)","1","S","DISPLAYBASE","11050"  
 "VEGATN","VEGATN","VEGATN","VEGATN"  
 "VEGATN","CATVEG7","AP(VEGATN04);LS(DASH,1,LANDF)","3","S","OTHER","32030"  
 "VEGATN","CATVEG21","AP(VEGATN04);LS(DASH,1,LANDF)","3","S","OTHER","32030"  
 "VEGATN","CATVEG3","AP(VEGATN03);LS(DASH,1,LANDF)","3","S","OTHER","32030"  
 "VEGATN","CATVEG4","AP(VEGATN03);LS(DASH,1,LANDF)","3","S","OTHER","32030"  
 "VEGATN","CATVEG5","AP(VEGATN03);LS(DASH,1,LANDF)","3","S","OTHER","32030"  
 "VEGATN","CATVEG6","AP(VEGATN03);LS(DASH,1,LANDF)","3","S","OTHER","32030"  
 "VEGATN","CATVEG13","AP(VEGATN03);LS(DASH,1,LANDF)","3","S","OTHER","32030"  
 "VEGATN","CATVEG14","AP(VEGATN03);LS(DASH,1,LANDF)","3","S","OTHER","32030"  
 "VEGATN","CATVEG15","AP(VEGATN03);LS(DASH,1,LANDF)","3","S","OTHER","32030"  
 "VEGATN","CATVEG16","AP(VEGATN03);LS(DASH,1,LANDF)","3","S","OTHER","32030"  
 "VEGATN","CATVEG17","AP(VEGATN03);LS(DASH,1,LANDF)","3","S","OTHER","32030"  
 "VEGATN","CATVEG18","AP(VEGATN03);LS(DASH,1,LANDF)","3","S","OTHER","32030"  
 "VEGATN","CATVEG19","AP(VEGATN03);LS(DASH,1,LANDF)","3","S","OTHER","32030"  
 "VEGATN","CATVEG20","AP(VEGATN03);LS(DASH,1,LANDF)","3","S","OTHER","32030"  
 "VEGATN","CATVEG22","AP(VEGATN03);LS(DASH,1,LANDF)","3","S","OTHER","32030"

```

"WATTUR","","SY(WATTUR02);LS(DASH,1,CHGRD)","4","S","OTHER","33040"
"WEDKLP","","SY(WEDKLP03);LS(DASH,1,CHGRF)","3","O","OTHER","34020"
"WRECKS","","CS(WRECKS04)","4","S","OTHER","34050"
"WRECKS","CATWRK3VALSOU","LC(NAVARE51)","4","S","OTHER","34051"
"WRECKS","CATWRK3","LC(NAVARE51)","4","S","OTHER","34050"
*
* ***                ***
* *** section two: NON-STANDARD CLASSES ***
* ***                ***
*
*Note: category "DISPLAYBASE" should not be removed from the display.
*For non-standard classes, all category "MARINERS STANDARD" and "MARINERS OTHER"
*should be drawn when "STANDARD DISPLAY" is drawn, and thereafter may be re-assigned
*to the category of chosen by the mariner.
*
"dnghtl","","AC(DNGHL,3);LS(SOLD,3,DNGHL)","8","O","MARINERS STANDARD","53010"
"marfea","","AC(ADINF,3);TX(OBJNAM,1,2,3,'15110',0,0,CHBLK,50);LS(SOLD,2,NINFO);LS(SOLD,1,CHBLK);","8","S","MARINERS STANDARD","53050"
"mnufea","","LS(DASH,2,ADINF)","5","S","MARINERS STANDARD","55010"
*
* ***                ***
* *** end of look-up table ***
* ***                ***

```

### 11.3.2 Look-up Table for areas with plain boundaries

```

* *** AREAS WITH PLAIN BOUNDARIES ***
* *** This is the look-up table for area symbolization. ***
* *** For edition 3.4 Preslib, dated January 2008 *****
*
* Each line contains minimum 6 fields:
* 1. field - code of the object class
* 2. field - attribute combination
* 3. field - symbolization instruction
* 4. field - display priority
* 5. field - radar
* 6. field - IMO display category
* 7. field - viewing group (optional)
*
* Each field entry is framed by "" and fields are separated by '!'.
*
* Please note, that the entries to this table must be in

```



"CAUSWY", "", "AC(CHBRN);LS(SOLD,1,CSTLN)", "5", "S", "STANDARD", "22010"  
 "CAUSWY", "WATLEV4", "AC(DEPIT);LS(DASH,2,CSTLN)", "5", "S", "STANDARD", "22010"  
 "CBLARE", "", "SY(CBLARE51);LS(DASH,2,CHMGD);CS(RESTRN01)", "3", "S", "STANDARD", "26230"  
 "CHKPNT", "", "SY(POSGEN04)", "4", "S", "OTHER", "32410"  
 "CONVYR", "", "TE('clr %4.1f', 'VERCLR', 3, 1, 2, '15110', 1, 0, CHBLK, 11);LS(SOLD, 3, CHGRD)", "8", "O", "DISPLAYBASE", "12210"  
 "CONVYR", "CONRAD1", "SY(RACNSP01);TE('clr %4.1f', 'VERCLR', 3, 1, 2, '15110', 1, 0, CHBLK, 11);LS(SOLD, 3, CHGRD)", "8", "O", "DISPLAYBASE", "12210"  
 "CONVYR", "CONRAD3", "SY(RACNSP01);TE('clr %4.1f', 'VERCLR', 3, 1, 2, '15110', 1, 0, CHBLK, 11);LS(SOLD, 3, CHGRD)", "8", "O", "DISPLAYBASE", "12210"  
 "CONZNE", "", "LS(DASH, 2, CHGRF)", "2", "S", "OTHER", "36050"  
 "COSARE", "", "LS(DASH, 2, CHGRF)", "2", "S", "OTHER", "36010"  
 "CRANES", "", "AC(CHBRN);LS(SOLD, 1, LANDF)", "4", "S", "OTHER", "32440"  
 "CRANES", "CONVIS1", "AC(CHBRN);LS(SOLD, 1, CHBLK)", "4", "S", "STANDARD", "22220"  
 "CTNARE", "", "SY(CTNARE51);LS(DASH, 2, TRFCD)", "3", "S", "STANDARD", "26050"  
 "CTSARE", "", "SY(INFARE51);LS(DASH, 1, CHMGF)", "3", "S", "STANDARD", "26250"  
 "CUSZNE", "", "LS(DASH, 1, CHGRF)", "2", "S", "OTHER", "36020"  
 "DAMCON", "", "AC(CHBRN);LS(SOLD, 1, LANDF)", "3", "S", "STANDARD", "22010"  
 "DAMCON", "CATDAM3", "AC(CHBRN);LS(SOLD, 2, CSTLN)", "6", "S", "DISPLAYBASE", "12410"  
 "DEPARE", "", "CS(DEPARE02)", "1", "S", "DISPLAYBASE", "13030"  
 "DEPARE", "DRVAL1?DRVAL2?", "AC(NODTA);AP(PRTSUR01);LS(SOLD, 2, CHGRD)", "1", "S", "DISPLAYBASE", "13030"  
 "DMPGRD", "", "SY(INFARE51);LS(DASH, 1, CHMGD);CS(RESTRN01)", "3", "S", "STANDARD", "26240"  
 "DOCARE", "", "AC(DEPVS);TX(OBJNAM, 1, 2, 3, '15110', 0, 0, CHBLK, 26);LS(SOLD, 1, CHBLK)", "2", "S", "DISPLAYBASE", "12420"  
 "DOCARE", "CONDTN", "AC(DEPVS);TX(OBJNAM, 1, 2, 3, '15110', 0, 0, CHBLK, 26);LS(DASH, 1, CHBLK)", "2", "S", "DISPLAYBASE", "12420"  
 "DRGARE", "", "CS(DEPARE02)", "1", "S", "DISPLAYBASE", "13030"  
 "DRYDOC", "", "AC(LANDA);LS(SOLD, 1, CSTLN)", "4", "S", "OTHER", "32440"  
 "DWRTP", "", "SY(TSLDEF51);SY(DWRTP51);LS(DASH, 3, TRFCD);CS(RESTRN01)", "4", "S", "STANDARD", "15010 25010"  
 "DWRTP", "ORIENTTRAFIC1", "SY(TSSLPT51, ORIENT);SY(DWRTP51);LS(DASH, 3, TRFCD);CS(RESTRN01)", "4", "S", "STANDARD", "25010"  
 "DWRTP", "ORIENTTRAFIC2", "SY(TSSLPT51, ORIENT);SY(DWRTP51);LS(DASH, 3, TRFCD);CS(RESTRN01)", "4", "S", "STANDARD", "25010"  
 "DWRTP", "ORIENTTRAFIC3", "SY(TSSLPT51, ORIENT);SY(DWRTP51);LS(DASH, 3, TRFCD);CS(RESTRN01)", "4", "S", "STANDARD", "25010"  
 "DWRTP", "ORIENTTRAFIC4", "SY(DWRUTE51, ORIENT);SY(DWRTP51);LS(DASH, 3, TRFCD);CS(RESTRN01)", "4", "S", "STANDARD", "25010"  
 "DYKCON", "", "AC(CHBRN);LS(SOLD, 1, LANDF)", "3", "S", "STANDARD", "22010"  
 "EXEZNE", "", "LS(DASH, 2, CHGRF)", "2", "S", "OTHER", "36050"  
 "FAIRWY", "", "LS(DASH, 1, CHGRD);CS(RESTRN01)", "4", "S", "STANDARD", "26050"  
 "FAIRWY", "ORIENTTRAFIC1", "SY(FAIRWY51, ORIENT);LS(DASH, 1, CHGRD);CS(RESTRN01)", "4", "S", "STANDARD", "26050"  
 "FAIRWY", "ORIENTTRAFIC2", "SY(FAIRWY51, ORIENT);LS(DASH, 1, CHGRD);CS(RESTRN01)", "4", "S", "STANDARD", "26050"  
 "FAIRWY", "ORIENTTRAFIC3", "SY(FAIRWY51, ORIENT);LS(DASH, 1, CHGRD);CS(RESTRN01)", "4", "S", "STANDARD", "26050"  
 "FAIRWY", "ORIENTTRAFIC4", "SY(FAIRWY52, ORIENT);LS(DASH, 1, CHGRD);CS(RESTRN01)", "4", "S", "STANDARD", "26050"  
 "FERYRT", "", "SY(FRYARE51);LS(DASH, 2, CHMGD)", "3", "S", "STANDARD", "26040"  
 "FERYRT", "CATFRY2", "SY(FRYARE52);LS(DASH, 2, CHBLK)", "3", "S", "STANDARD", "26040"  
 "FLODOC", "", "AC(CHBRN);LS(SOLD, 2, CSTLN)", "5", "S", "DISPLAYBASE", "12410"  
 "FORSTC", "", "AC(CHBRN);LS(SOLD, 1, LANDF)", "4", "S", "OTHER", "32220"  
 "FORSTC", "CONVIS1", "AC(CHBRN);LS(SOLD, 1, CHBLK)", "4", "S", "STANDARD", "22220"  
 "FRPARE", "", "LS(DASH, 2, CHGRF)", "2", "S", "OTHER", "36020"  
 "FSHFAC", "", "AP(FSHHAV02);LS(DASH, 1, CHGRD)", "4", "S", "OTHER", "34040"  
 "FSHFAC", "CATFIF1", "AP(FSHFAC03);LS(DASH, 1, CHGRD)", "4", "S", "OTHER", "34040"  
 "FSHFAC", "CATFIF2", "AP(FSHFAC04);LS(DASH, 1, CHGRD)", "4", "S", "OTHER", "34040"  
 "FSHFAC", "CATFIF3", "AP(FSHFAC04);LS(DASH, 1, CHGRD)", "4", "S", "OTHER", "34040"  
 "FSHFAC", "CATFIF4", "AP(FSHFAC04);LS(DASH, 1, CHGRD)", "4", "S", "OTHER", "34040"  
 "FSHGRD", "", "SY(FSHGRD01);LS(DASH, 2, CHGRF)", "3", "S", "STANDARD", "26210"  
 "FSHZNE", "", "LS(DASH, 2, CHGRF)", "2", "S", "OTHER", "36040"  
 "GATCON", "", "AC(CHBRN);LS(SOLD, 2, CSTLN)", "8", "S", "DISPLAYBASE", "12410"





"OBSTRN","CATOBS7","SY(FOULGND1);LS(DASH,1,CHGRD)","4","S","OTHER","34050"  
"OBSTRN","CATOBS8","SY(FLTHAZ02);LS(DASH,1,CSTLN)","4","S","DISPLAYBASE","12410"  
"OBSTRN","CATOBS9","SY(ACHARE02);LS(DASH,1,CHMGD)","4","S","DISPLAYBASE","12410"  
"OBSTRN","CATOBS10","SY(FLTHAZ02);LS(DASH,1,CSTLN)","4","S","DISPLAYBASE","12410"  
"OBSTRN","WATLEV7","SY(FLTHAZ02);LS(DASH,1,CSTLN)","4","S","DISPLAYBASE","12410"  
"OFSPLF","","AC(CHBRN);LS(SOLD,4,CSTLN);TE('Prod %s',OBJNAM,3,1,2,'15110',1,-1,CHBLK,21),"5","O","DISPLAYBASE","12210"  
"OSPARE","","SY(CTYARE51);LS(DASH,2,CHMGD);CS(RESTRN01)","4","S","STANDARD","26040"  
"PILBOP","","SY(PILBOP02);LS(DASH,2,TRFCF)","4","S","STANDARD","28010"  
"PIPARE","","SY(INFARE51);LS(DASH,2,CHMGD);CS(RESTRN01)","3","S","STANDARD","26230"  
"PIPARE","CATPIP2","SY(INFARE51);LS(DASH,2,CHGRD);CS(RESTRN01)","3","S","STANDARD","26230"  
"PIPARE","CATPIP3","SY(INFARE51);LS(DASH,2,CHGRD);CS(RESTRN01)","3","S","STANDARD","26230"  
"PIPARE","PRODC3","SY(INFARE51);LS(DASH,2,CHGRD);CS(RESTRN01)","3","S","STANDARD","26230"  
"PONTON","","AC(CHBRN);LS(SOLD,2,CSTLN)","5","S","DISPLAYBASE","12410"  
"PRCARE","","SY(PRCARE51);LS(DASH,2,TRFCD);CS(RESTRN01)","4","S","STANDARD","25010"  
"PRDARE","","LS(DASH,1,LANDF)","4","S","OTHER","32270"  
"PRDARE","CATPRA5CONVIS1","SY(RFNERY11);LS(DASH,1,CHBLK)","4","S","STANDARD","22220"  
"PRDARE","CATPRA8CONVIS1","SY(TNKFRM11);LS(DASH,1,CHBLK)","4","S","STANDARD","22220"  
"PRDARE","CATPRA9CONVIS1","SY(WNDFRM61);LS(DASH,1,CHBLK)","4","S","STANDARD","22220"  
"PRDARE","CATPRA1","SY(QUARRY01);LS(DASH,1,LANDF)","4","S","OTHER","32270"  
"PRDARE","CATPRA5","SY(RFNERY01);LS(DASH,1,LANDF)","4","S","OTHER","32270"  
"PRDARE","CATPRA6","SY(TMBYRD01);LS(DASH,1,LANDF)","4","S","OTHER","32270"  
"PRDARE","CATPRA8","SY(TNKFRM01);LS(DASH,1,LANDF)","4","S","OTHER","32270"  
"PRDARE","CATPRA9","SY(WNDFRM51);LS(DASH,1,LANDF)","4","S","OTHER","32270"  
"PYLONS","","AC(CHBRN);LS(SOLD,2,CSTLN)","6","S","DISPLAYBASE","12210"  
"RADRNG","","LS(DASH,1,TRFCF)","3","S","STANDARD","25040"  
"RAPIDS","","AC(CHGRD)","3","S","OTHER","32050"  
"RCTLPT","","SY(RTLDEF51)","4","S","STANDARD","25020"  
"RCTLPT","ORIENT","SY(RCTLPT52,ORIENT)","4","S","STANDARD","25020"  
"RECTRC","","SY(RECDEF51);LS(DASH,1,CHGRD)","6","S","STANDARD","25020"  
"RECTRC","ORIENTCATTRK1TRAFIC1","SY(RECTRC58,ORIENT);TE('%03.0lf deg',ORIENT,3,2,2,'15110',4,0,CHBLK,11);LS(DASH,1,CHGRD)","6","S","STANDARD","25020"  
"RECTRC","ORIENTCATTRK1TRAFIC2","SY(RECTRC58,ORIENT);TE('%03.0lf deg',ORIENT,3,2,2,'15110',4,0,CHBLK,11);LS(DASH,1,CHGRD)","6","S","STANDARD","25020"  
"RECTRC","ORIENTCATTRK1TRAFIC3","SY(RECTRC58,ORIENT);TE('%03.0lf deg',ORIENT,3,2,2,'15110',4,0,CHBLK,11);LS(DASH,1,CHGRD)","6","S","STANDARD","25020"  
"RECTRC","ORIENTCATTRK1TRAFIC4","SY(RECTRC56,ORIENT);TE('%03.0lf deg',ORIENT,3,2,2,'15110',4,0,CHBLK,11);LS(DASH,1,CHGRD)","6","S","STANDARD","25020"  
"RECTRC","ORIENTCATTRK2TRAFIC1","SY(RECTRC57,ORIENT);TE('%03.0lf deg',ORIENT,3,2,2,'15110',4,0,CHBLK,11);LS(DASH,1,CHGRD)","6","S","STANDARD","25020"  
"RECTRC","ORIENTCATTRK2TRAFIC2","SY(RECTRC57,ORIENT);TE('%03.0lf deg',ORIENT,3,2,2,'15110',4,0,CHBLK,11);LS(DASH,1,CHGRD)","6","S","STANDARD","25020"  
"RECTRC","ORIENTCATTRK2TRAFIC3","SY(RECTRC57,ORIENT);TE('%03.0lf deg',ORIENT,3,2,2,'15110',4,0,CHBLK,11);LS(DASH,1,CHGRD)","6","S","STANDARD","25020"  
"RECTRC","ORIENTCATTRK2TRAFIC4","SY(RECTRC55,ORIENT);TE('%03.0lf deg',ORIENT,3,2,2,'15110',4,0,CHBLK,11);LS(DASH,1,CHGRD)","6","S","STANDARD","25020"  
"RECTRC","ORIENTTRAFIC1","SY(RECTRC57,ORIENT);TE('%03.0lf deg',ORIENT,3,2,2,'15110',4,0,CHBLK,11);LS(DASH,1,CHGRD)","6","S","STANDARD","25020"  
"RECTRC","ORIENTTRAFIC2","SY(RECTRC57,ORIENT);TE('%03.0lf deg',ORIENT,3,2,2,'15110',4,0,CHBLK,11);LS(DASH,1,CHGRD)","6","S","STANDARD","25020"  
"RECTRC","ORIENTTRAFIC3","SY(RECTRC57,ORIENT);TE('%03.0lf deg',ORIENT,3,2,2,'15110',4,0,CHBLK,11);LS(DASH,1,CHGRD)","6","S","STANDARD","25020"  
"RECTRC","ORIENTTRAFIC4","SY(RECTRC55,ORIENT);TE('%03.0lf deg',ORIENT,3,2,2,'15110',4,0,CHBLK,11);LS(DASH,1,CHGRD)","6","S","STANDARD","25020"  
"RESARE","","CS(RESARE03)","5","S","STANDARD","26010"  
"RESARE","CATREA27","SY(ESSARE01);LC(ESSARE01)","5","S","STANDARD","26010"  
"RESARE","CATREA28","SY(PSSARE01);LC(ESSARE01)","5","S","STANDARD","26010"  
"RIVERS","","AC(DEPVS);LS(SOLD,1,CHBLK)","2","S","DISPLAYBASE","12420"  
"ROADWY","","AC(LANDA);LS(SOLD,1,LANDF)","4","S","OTHER","32250"  
"RUNWAY","","AC(CHBRN)","5","S","OTHER","32240"  
"RUNWAY","CONVIS1","AC(CHBRN);LS(SOLD,1,CHBLK)","5","S","STANDARD","22220"  
"SBDARE","","TX(NATSUR,1,2,2,'15110',0,0,CHBLK,25),"3","O","OTHER","34010"

"SBDARE","WATLEV3NATSUR","TX(NATSUR,1,2,2,'15110',0,0,CHBLK,25);LS(DASH,1,CHGRD)","3","S","OTHER","34010"  
 "SBDARE","WATLEV4NATSUR9","AP(RCKLDG01);LS(DASH,1,CHGRD)","3","S","OTHER","34010"  
 "SBDARE","WATLEV4NATSUR11","AP(RCKLDG01);LS(DASH,1,CHGRD)","3","S","OTHER","34010"  
 "SBDARE","WATLEV4NATSUR14","AP(RCKLDG01);LS(DASH,1,CHGRD)","3","S","OTHER","34010"  
 "SBDARE","WATLEV4NATSUR","TX(NATSUR,1,2,2,'15110',0,0,CHBLK,25);LS(DASH,1,CHGRD)","3","S","OTHER","34010"  
 "SEAARE","TX(OBJNAM,1,2,3,'15110',0,0,CHBLK,26)","3","S","STANDARD","21060"  
 "SILTNK","AC(CHBRN);LS(SOLD,1,LANDF)","4","S","OTHER","32220"  
 "SILTNK","CONVIS1","AC(CHBRN);LS(SOLD,1,CHBLK)","4","S","STANDARD","22220"  
 "SLCONS","CS(SLCONS03)","7","S","DISPLAYBASE","12410"  
 "SLOGRD","","",""  
**"SLOGRD","CATSLO1CONRAD1","AC(CHGRD);LS(SOLD,1,CHBLK)","3","S","OTHER","32010"**  
**"SLOGRD","CATSLO2CONRAD1","AC(CHGRD);LS(SOLD,1,CHBLK)","3","S","OTHER","32010"**  
**"SLOGRD","CATSLO3CONRAD1","AC(CHGRD);LS(SOLD,1,CHBLK)","3","S","OTHER","32010"**  
**"SLOGRD","CATSLO4CONRAD1","AC(CHGRD);LS(SOLD,1,CHBLK)","3","S","OTHER","32010"**  
**"SLOGRD","CATSLO5CONRAD1","AC(CHGRD);LS(SOLD,1,CHBLK)","3","S","OTHER","32010"**  
 "SLOGRD","CATSLO6","AC(CHGRD)","3","S","OTHER","32010"  
**"SLOGRD","CATSLO7CONRAD1","AC(CHGRD);LS(SOLD,1,CHBLK)","3","S","OTHER","32010"**  
 "SMCFAC","AC(CHBRN);SY(SMCFAC02);LS(SOLD,1,LANDF)","4","S","OTHER","38210"  
 "SNDWAV","AP(SNDWAV01);LS(DASH,2,CHGRD)","4","S","STANDARD","24010"  
 "SPLARE","SY(CTYARE51);LS(DASH,1,CHMGD);CS(RESTRN01)","4","S","STANDARD","26040"  
 "SUBTLN","SY(CTYARE51);LS(DASH,1,CHMGD);CS(RESTRN01)","4","S","STANDARD","26040"  
 "SWPARE","SY(SWPARE51);TE('swept to %5.1lf','DRVAL1',1,2,2,'15110',0,1,CHBLK,27);LS(DASH,1,CHGRD)","4","S","STANDARD","23030"  
 "T\_HMON","SY(TIDEHT01);LS(DASH,1,CHGRD)","2","S","OTHER","33050"  
 "T\_NHMN","SY(TIDEHT01);LS(DASH,1,CHGRD)","2","S","OTHER","33050"  
 "T\_TIMS","SY(TIDEHT01);LS(DASH,1,CHGRD)","2","S","OTHER","33050"  
 "TS\_FEB","SY(CURDEF01);LS(DASH,1,CHGRD)","2","S","OTHER","33060"  
 "TS\_FEB","CAT\_TS1ORIENT","SY(FLDSTR01,ORIENT);TE('%4.1lf kn','CURVEL',3,1,2,'15110',1,-1,CHBLK,31)","4","S","OTHER","33060"  
 "TS\_FEB","CAT\_TS2ORIENT","SY(EBBSTR01,ORIENT);TE('%4.1lf kn','CURVEL',3,1,2,'15110',1,-1,CHBLK,31)","4","S","OTHER","33060"  
 "TS\_FEB","CAT\_TS3ORIENT","SY(CURENT01,ORIENT);TE('%4.1lf kn','CURVEL',3,1,2,'15110',1,-1,CHBLK,31)","4","S","OTHER","33060"  
 "TS\_PAD","SY(TIDSTR01);LS(DASH,1,CHGRD)","2","S","OTHER","33060"  
 "TS\_PNH","SY(TIDSTR01);LS(DASH,1,CHGRD)","2","S","OTHER","33060"  
 "TS\_PRH","SY(TIDSTR01);LS(DASH,1,CHGRD)","2","S","OTHER","33060"  
 "TS\_TIS","SY(TIDSTR01);LS(DASH,1,CHGRD)","2","S","OTHER","33060"  
 "TESARE","LS(DASH,2,CHGRF);CS(RESTRN01)","2","S","OTHER","36050"  
 "TIDEWY","LS(DASH,1,CHGRF);TX(OBJNAM,1,2,3,'15110',0,0,CHBLK,25)","7","S","OTHER","32070"  
 "TSEZNE","AC(TRFCF,3)","4","S","STANDARD","25010"  
 "TSSCRS","AP(TSSJCT02);SY(TSSCRS51);CS(RESTRN01)","6","S","STANDARD","25010"  
 "TSSLPT","SY(CTNARE51);TX(INFORM,1,1,2,'15110',0,-2,CHBLK,24);CS(RESTRN01)","6","S","STANDARD","25010"  
 "TSSLPT","ORIENT","SY(TSSLPT51,ORIENT);CS(RESTRN01)","6","S","STANDARD","25010"  
 "TSSRON","SY(TSSRON51);CS(RESTRN01)","6","S","STANDARD","25010"  
 "TUNNEL","LS(DASH,1,CHGRD)","4","S","OTHER","32250"  
 "TUNNEL","BURDEP0","AC(DEPVS);LS(DASH,1,CHBLK)","4","S","STANDARD","24010"  
 "TWRTPPT","SY(TWRDEF51);LS(DASH,4,TRFCD)","4","S","STANDARD","25010"  
 "TWRTPPT","ORIENTTRAFFIC1","SY(TWRTPPT53,ORIENT);LS(DASH,4,TRFCD)","4","S","STANDARD","25010"  
 "TWRTPPT","ORIENTTRAFFIC2","SY(TWRTPPT53,ORIENT);LS(DASH,4,TRFCD)","4","S","STANDARD","25010"  
 "TWRTPPT","ORIENTTRAFFIC3","SY(TWRTPPT53,ORIENT);LS(DASH,4,TRFCD)","4","S","STANDARD","25010"  
 "TWRTPPT","ORIENTTRAFFIC4","SY(TWRTPPT52,ORIENT);LS(DASH,4,TRFCD)","4","S","STANDARD","25010"  
 "UNSARE","AC(NODTA);AP(NODATA03);LS(SOLD,2,CHGRD)","1","S","DISPLAYBASE","11050"  
 "VEGATN","","",""

"VEGATN","CATVEG7","AP(VEGATN04);LS(DASH,1,LANDF)","3","S","OTHER","32030"  
 "VEGATN","CATVEG21","AP(VEGATN04);LS(DASH,1,LANDF)","3","S","OTHER","32030"  
 "VEGATN","CATVEG3","AP(VEGATN03);LS(DASH,1,LANDF)","3","S","OTHER","32030"  
 "VEGATN","CATVEG4","AP(VEGATN03);LS(DASH,1,LANDF)","3","S","OTHER","32030"  
 "VEGATN","CATVEG5","AP(VEGATN03);LS(DASH,1,LANDF)","3","S","OTHER","32030"  
 "VEGATN","CATVEG6","AP(VEGATN03);LS(DASH,1,LANDF)","3","S","OTHER","32030"  
 "VEGATN","CATVEG13","AP(VEGATN03);LS(DASH,1,LANDF)","3","S","OTHER","32030"  
 "VEGATN","CATVEG14","AP(VEGATN03);LS(DASH,1,LANDF)","3","S","OTHER","32030"  
 "VEGATN","CATVEG15","AP(VEGATN03);LS(DASH,1,LANDF)","3","S","OTHER","32030"  
 "VEGATN","CATVEG16","AP(VEGATN03);LS(DASH,1,LANDF)","3","S","OTHER","32030"  
 "VEGATN","CATVEG17","AP(VEGATN03);LS(DASH,1,LANDF)","3","S","OTHER","32030"  
 "VEGATN","CATVEG18","AP(VEGATN03);LS(DASH,1,LANDF)","3","S","OTHER","32030"  
 "VEGATN","CATVEG19","AP(VEGATN03);LS(DASH,1,LANDF)","3","S","OTHER","32030"  
 "VEGATN","CATVEG20","AP(VEGATN03);LS(DASH,1,LANDF)","3","S","OTHER","32030"  
 "VEGATN","CATVEG22","AP(VEGATN03);LS(DASH,1,LANDF)","3","S","OTHER","32030"  
 "WATTUR","","SY(WATTUR02);LS(DASH,1,CHGRD)","4","S","OTHER","33040"  
 "WEDKLP","","SY(WEDKLP03);LS(DASH,1,CHGRF)","3","O","OTHER","34020"  
 "WRECKS","","CS(WRECKS04)","4","S","OTHER","34050"  
 "WRECKS","CATWRK3VALSOU","LS(DASH,1,CHBLK)","4","S","OTHER","34051"  
 "WRECKS","CATWRK3","LS(DASH,1,CHBLK)","4","S","OTHER","34050"

\*

\* \*\*\*

\*\*\*

\* \*\*\* section two: NON-STANDARD CLASSES \*\*\*

\* \*\*\*

\*\*\*

\*

\*Note: category "DISPLAYBASE" should not be removed from the display.

\*For non-standard classes, all category "MARINERS STANDARD" and "MARINERS OTHER"

\*should be drawn when "STANDARD DISPLAY" is drawn, and thereafter may be re-assigned

\*to the category of chosen by the mariner.

\*

"dnght","","AC(DNGHL,3);LS(SOLD,3,DNGHL)","8","O","MARINERS STANDARD","53010"

"marfea","","AC(ADINF,3);TX(OBJNAM,1,2,3,'15110',0,0,CHBLK,50);LS(SOLD,2,NINFO);LS(SOLD,1,CHBLK);","8","S","MARINERS STANDARD","53050"

"mnufea","","LS(DASH,2,ADINF)","5","S","MARINERS STANDARD","55010"

\*

\* \*\*\*

\*\*\*

\* \*\*\* end of look-up table \*\*\*

\* \*\*\*

\*\*\*

Item No.PL03.4.d8.ad.3 Addition to PresLib symbol description (Users' Manual Addendum)  
**CHECKPOINT symbol**

Symbol Name:	SY(CHKPNT01)
RN:	590

Symbol Explanation: customs symbo

Look up table affected: area symbols with plain boundaries  
 area symbols with symbolized boundaries  
 paper chart point symbols  
 simplified point symbols

Pivot Point Column: 2.00  
 Pivot Point Row: 2.00

Width of Bounding Box: 4.00  
 Height of Bounding Box: 4.00

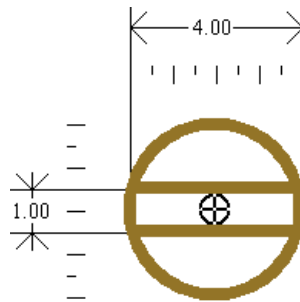

Symbol Colours:  LANDF

Comments: Line weight 0.3 mm  
 Circle diameter 4.00 mm

Examples on ENC: N/A

References:

S57	INT 1	
BUISGL	F 61	

Item No. PL03.4.d8.co.4 Correction of symbol names & meaning  
**correct several symbol names**

## VESSEL02

Conditional symbology procedure for symbolizing «other vessels» than own-ship, and for drawing the associated vectors and heading lines.

The «other vessel» is symbolized in a manner depending on whether the source is ARPA or AIS, and on which other options are selected by the mariner:

1. Show vessel symbol only:

- 1.1 ARPA target selected (vessel, vesrce1): show SY (ARPATG01) at the position indicated.
- 1.2 AIS 'sleeping target' selected - (vessel, vesrce2, vestat2, headng): show SY(AISSLP042) «sleeping target» at the position indicated and rotate the symbol in the direction given by (headng).
- 1.3 AIS 'lost' target (vessel, vesrce2, vestat5, headng): show SY(AISLST042) at the position indicated and rotate the symbol in the direction given by the last (headng) report.

2. Show vessel symbol, heading line and course and speed vector:

(Note that the time period which determines the scaling of vector length must be the same for all vectors.)

2.1 ARPA

- 2.1.1 ARPA target selected (vessel, vesrcel, vecper,...): show SY(ARPATG01) at the position indicated.

2.1.2 *(There is no heading line from ARPA).*

- 2.1.3 Vector, starting at the pivot point of the vessel symbol, draw a line scaled by the vector period (vecper) and the speed (sogspd or stwspd), in the direction given by the course (cogcrs or ctwcrs). (The vector period is selected by the mariner). Linestyle is LS(SOLD,2,ARPAT).

2.2 AIS

- 2.2.1 AIS target selected (vessel, vesrce2, vestat1 or 3 or 4, vecper,...) :

Symbolise the vessel as follows:

- vestat1 ('activated') show SY(AISVES042) 'activated AIS target'
- vestat3 ('selected') show SY(AISSEL01) 'selected AIS target' \*
- vestat4 ('dangerous') show SY(AISDGR01) 'dangerous AIS target' \*\*

Rotate the symbol in the direction given by (headng)

\* (detailed information for a 'selected AIS target' is shown in a separate data display area.)

\*\* (the 'dangerous AIS target' is coloured red. If the signal from a dangerous target is lost show a flashing lost target symbol until this alarm is acknowledged.)

- 2.2.2 Heading line and turn indications: starting at the bow (apex of the vessel symbol) draw a line 50mm in length in the direction given by (headng).

Linestyle is LS(SOLD,1,ARPAT). If available, show the direction of a turn indication at the end of the heading line: SY(AISTRN043) for a turn to starboard, SY(AISTRN024) for a turn to port.

- 2.2.3 Vector: starting at the pivot point of the vessel symbol draw a line scaled by the vector period (vecper) selected by the mariner and the speed (sogspd) in the direction given by the course (cogcrs). Linestyle is LS(DASH,2,ARPAT). Alternatively, a path predictor may be provided using the same linestyle. (Note that the course and speed vector and heading, plus the direction and rate of turn if available, are always drawn for activated AIS targets.)
3. Show vector stabilization for ARPA
- 3.1 For ground stabilization (vessel, vecstb1,...): place SY(VECGND21) at the end of the vector, replacing the last time mark. Rotate the symbol in the direction given by (cogcrs).
- 3.2 For water stabilization (vessel, vecstb2,...): place SY(VECWTR21) at the end of the vector, replacing the last time mark. Rotate the symbol in the direction given by (ctwcrs).
4. Show time marks on vector
- 4.1 ARPA target selected (vessel, vesrcel,...):
- 4.1.1 One-minute marks selected (vessel, vesrce1 ,vecmrk1,... ): place SY(ARPSIX01) at every sixth minute mark, and SY(ARPONE01) at every remaining one-minute mark. Rotate all symbols in the direction given by (cogcrs or ctwcrs).
- 4.1.2 Only six-minute marks selected (vessel, vecmrk2,... ): place SY(ARPSIX01) at every six-minute mark. Rotate in the direction given by (cogcrs or ctwcrs).
- 4.2 (Note that there are no time marks on AIS vectors)

### 15.3/15.6 List of symbol names & meanings arranged numerically/alphabetically

#### Point symbols & centred area symbols (SY)

11.	SY(AISSLP042)	ARPATRESBLU	sleeping AIS target
12.	SY(AISVES042)	ARPATRESBLU	active AIS target showing vector and/or heading

#### Symbols added since Edition 3.0

580.	SY(AISLST01)	RESBLUDNGHL	lost AIS target
589.	SY(DGPS04DRFSTA01)	CHMGD	DGPS Base station

Item No. PL03.4.d8.ad.5 Addition of TECSOU = 4 (found by diver) to harmonise wreck symbolisation with INT 1  
**SNDFRM04**

